



Hubbell Industrial Controls, Inc.

EUCLID™ PBP PENDANT PUSHBUTTON STATIONS ASSEMBLY AND PARTS INFORMATION

- Step #1** Position hanger bracket (Item 1) as required and tighten locking nut 1/3 turn past finger tight.
- Step #2** Pilot light assembly (Item 2) if used -- push out plug (P/N 28338) from rear. Insert light assembly. Insert pilot light legend plate. Install locking ring.
- Step #3** *Install button assembly (not Pictorially shown). Align keying tabs and holes and press push button assembly into terminal boards. Tighten hold down screws. (Not used on MS2 & MS5). AVOID OVERTIGHTENING
- Step #4** *Install terminal board with button assembly working from top to bottom. Use 8-32 x 1/2" (P/N 47661-098) "sems" screws (Item 4) where single thickness terminal board is fastened. Observe "Top" marking on each board. AVOID OVERTIGHTENING
- Step #5** *Use 8-32 x 5/8" (P/N 47661-100) "sems" screws (Item 5) where two terminal boards overlap. AVOID OVERTIGHTENING
- Step #6** Use 8-32 x 1/2" (P/N 47243-059) pan head screws (Item 6) to install button guards and back cover. CAUTION: DO NOT OVERTIGHTEN THESE SCREWS. Recommended torque is 10 in. lbs. To 12 in. lbs. Maximum. A slight rubber bulging is allowed.

* Where direct wired push buttons are used, Steps #3, #4, & #5 do not apply.

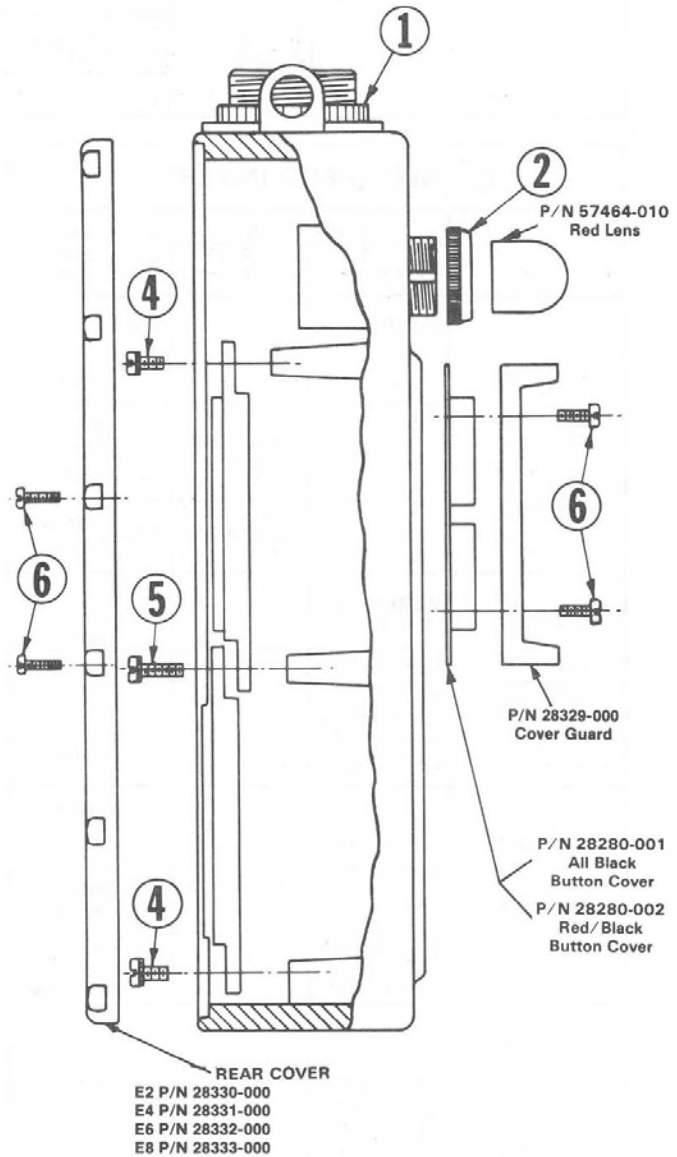

PILOT LIGHTS					
DESCRIPTION	CATALOG NUMBER	LAMP PART NO.	DESCRIPTION	CATALOG NUMBER	LAMP PART NO.
Pilot Light 120v 60 Hz AC	PL1	57465-015	Pilot Light 120V DC	PL3	57465-043
Pilot Light 240v 60 Hz AC	PL2	57465-015	Pilot Light 240v DC	PL4	57465-007

	ENCLOSURE DIMENSIONS				CONTACT INTERRUPTING RATINGS		
	MOTION	A	APPROX. WT. ASSEMBLED	CATALOG NO.	MULTI-SPEED SINGLE BREAK		
	1* 2 Buttons	7- ⁷ / ₈ "	2- ¹ / ₂ lbs.	E2	A.C. 35% PF	120v 240v	6A 3A
	2 4 Buttons	13- ¹¹ / ₁₆ "	4- ¹ / ₂ lbs.	E4	D.C. IND	125v 250v	.4A .2A
	3 6 Buttons	18"	5- ¹ / ₂ lbs.	E6	SINGLE SPEED DOUBLE BREAK		
	4 8 Buttons	22- ⁵ / ₁₆ "	7 lbs.	E8	A.C. 35% PF	120v 240v	6A 3A
* Pilot light is not available on 1 motion enclosure					D.C. IND.	125v 250v	1.1A .55A

SINGLE SPEED INSERT				
SYMBOL	DESCRIPTION		CAT. NO.	TYPICAL APPLI-CATIONS
	PLUG-IN*	DIRECT WIRED**		
	MOMENTARY N.O.	--	PG1	Crane control: trolley, bridge & hoist, etc.
	--	MOMENTARY N.O.	DW1	
	--	MAINTAINED	DWS	Start-Stop functions
	MOMENTARY N.O. & N.C.	--	PG2	Interlocking, crane control
	MAINTAINED N.O. & N.C.	--	PG3	Auxiliary functions
	MAINTAINED MOMENTARY LIFT/DROP	--	PG4 †	Magnet control
	MOMENTARY MAINTAINED	--	PG5 †	Used as a toggle switch and for start-stop functions
	MOMENTARY START-STOP RESET-STOP	--	PG6 •	Start-stop on-off functions
	MOMENTARY STOP-START STOP-RESET	--	PG7 •	Stop-start off-on functions

MULTI-SPEED INSERT			
SYMBOL	DESCRIPTION	CAT. NO.	TYPICAL APPLI-CATION
	PLUG-IN*		
	USED TO A MAXIMUM OF THREE SPEED POINTS	MS2	For multi-speed functions
		USED TO A MAXIMUM OF FIVE SPEED POINTS	MS5

† PG4 and PG5 inserts have one button maintained and one button momentary.
 * Terminal Base Cat. TB2 required for each plug-in insert PG1, PG2, PG3, PG4, PG5, PG6, PG7 and MS2. Terminal Base TB5 required for MS5 insert.
 **Terminal Base not required with direct wired unit.
 • "Power On-Off" buttons recommended to comply with provisions of NEMA ICS 3-442.15



Hubbell Industrial Controls, Inc.
 A subsidiary of Hubbell Incorporated
 4301 Cheyenne Dr., Archdale, NC. 27262
 Telephone (336) 434-2800 • FAX (336) 434-2803
<http://www.hubbell-icd.com>
Sales@hubbell-icd.com

Free Manuals Download Website

<http://myh66.com>

<http://usermanuals.us>

<http://www.somanuals.com>

<http://www.4manuals.cc>

<http://www.manual-lib.com>

<http://www.404manual.com>

<http://www.luxmanual.com>

<http://aubethermostatmanual.com>

Golf course search by state

<http://golfingnear.com>

Email search by domain

<http://emailbydomain.com>

Auto manuals search

<http://auto.somanuals.com>

TV manuals search

<http://tv.somanuals.com>