

## ADEMCO 5828/5828V

### Wireless Bidirectional Fixed-Word Keypads

## USER GUIDE

### GENERAL INFORMATION

The ADEMCO 5828 and 5828V are wireless keypads that can be used to operate and get status from your security system. The 5828 and 5828V have the following features (voice annunciation features apply only to the 5828V):

- Can be used to arm/disarm, and perform other system operations.
- Can display and/or annunciate system status.
- Can automatically display and/or annunciate a change in system status if AC powered (e.g., for an alarm, the keypad will announce the type of alarm (fire or burglary) and location (e.g. kitchen window).
- The 5828V Message Center can be used to record and play back a voice memo to yourself, or leave a message for a family member.
- Can be battery- or AC-powered (AC-powered units have several advantages, described below).

**Battery-Powered Operation:** When powered by battery, the keypad must first be activated by pressing any numbered key. The keypad will display the current system status within a few seconds. You may at any time before or after receiving status, arm, disarm, send a panic alarm, or perform other system operations. The keypad becomes inactive when no keys have been pressed for 15 seconds, and must be reactivated to display the current status.

**AC-Powered Operation:** When powered by the optional AC adapter, the keypad remains active at all times. If AC power is lost, the keypad reverts to battery-powered operation until AC power is restored and a new status request is made ([\*] key).

**NOTE:** Whether the unit is powered by battery or AC, the 5828/5828V may take a few seconds to display and/or annunciate the new status after pressing the [\*] key.

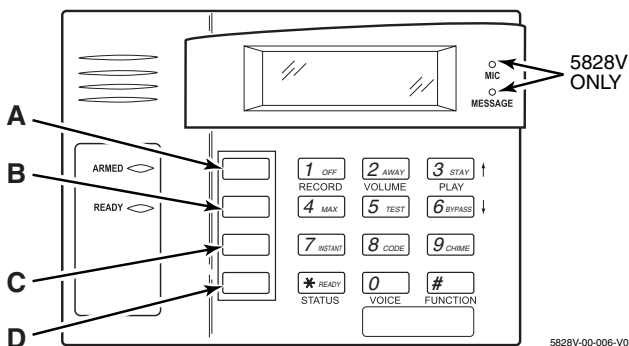

5828V Keypad with Front Cover Removed

### KEYPAD KEYS

These keypads include 12-operational keys, as well as four Special Function keys that are backlit for ease of use when the keypad is active. To access the keypad keys, simply open the swing-down door by applying outward pressure on the door release slot on the right side.

Panic alarms are activated by pressing the key pairs shown in the table below. Special Function keys A, B, and C, can be programmed by your installer to provide the same alarms by pressing a single key and holding it down for 3-seconds, or can be assigned other system operations. (Ask your installer to fill in the tables below with assigned functions of these keys).

Key Pairs	Function
[1] & [*]	
[*] & [#]	
[3] & [#]	

Function Keys	Function
A	
B	
C	
D	

### SOUNDER

The keypad's built-in sounder pulses three times and then pauses (repeatedly) for **fire** alarms, and generates a continuous two-tone sound for **burglary** alarms.

### HOW TO GET SYSTEM STATUS

#### When Powered By Battery

Pressing any key will turn on the keypad. However, to specifically request system status from the control, simply press the [\*] key. Status will be displayed within a few seconds.

#### When Powered By AC Power

On AC powered units you can get the status by viewing the display. The keypad is automatically updated when a change in system status takes place (arming, disarming, trouble, etc.).

### HOW TO PROGRAM OR CHANGE YOUR 4-DIGIT SECURITY CODE IF USING QUICK KEY FUNCTIONS

In order to Quick Arm the system using this keypad, you will need to program your own 4-digit security code into the keypad. This code **must** match a code that has already been programmed into your control panel. To program the 4-digit code, perform the following steps:

1. Press the **7 INSTANT** and **9 CHIME** keys at the same time until the display flashes double dashes (- -), then release.
2. Enter the 4-digit security code that matches a valid user code already programmed into your control panel. Do **NOT** use the Duress Code. **There will be no display of the numbers you pressed.**

- Press **\*READY** to accept your entry. The keypad will display the system status.

### MEMO/MESSAGE CENTER (5828V only)

#### Recording and playing back messages

The keystrokes required for message recording and playback are as shown in the table below.

In this table, read the + sign as “followed by.”

Example: # + 1 would be read as the [#] key followed by the [1] key.

MESSAGE CENTER (LYNX)	
TO:	PRESS:
Record a message:	# + 1
Stop recording before end of 20 seconds:	1
Playback a message:	# + 3
Adjust message playback volume:	# + 2 + 3↑ or 6↓
Mute system status announcements:	# + 2 + 1
Restore system status announcements:	# + 2 + 3↑ or 6↓
MESSAGE CENTER (VISTA)	
TO:	PRESS:
Record a message:	# + 0 + 1
Stop recording before end of 20 seconds:	1
Playback a message:	# + 0 + 3
Adjust message playback volume:	# + 0 + 2 + 3↑ or 6↓
Mute system status announcements:	# + 0 + 2 + 1
Restore system status announcements:	# + 0 + 2 + 3↑ or 6↓

**New message indication:** If powered by battery, the Message LED will **only** blink when you activate the keypad by requesting status. If powered by AC, the Message LED will blink continuously. Once the message is played back, the LED will no longer blink.

**NOTE:** If using a LYNX control, and the word “MESSAGE” is announced at the 5828V keypad, it means that there is a message waiting **at the control panel**, which can only be retrieved using the LYNX keypad.

#### MESSAGE CENTER NOTES

- Allow any alarm system status annunciation to **complete** before starting to record your message.
- Messages up to 20-seconds long may be recorded and played back at any time.
- When messages are first recorded, the red message LED will continuously flash to show that a new message is contained in the message center memory. Once that message is played back, the LED will no longer flash but the message is retained until a new message is recorded over it.
- A status announcement will interrupt the recording or playback of a message. If this happens, begin recording or playing the message back again.

If you **Mute system status announcements** for any reason, you must **Restore system status announcements** by pressing the keys indicated in the “MESSAGE CENTER” table (above) in order to hear them again. They will **not** restore on their own.

- Recording a message or playing back a stored message is **NOT** affected by muting.
- If you adjust** the volume (3↑ or 6↓) when you play back a message, and still want system status announcements to be muted, you must **again** mute system status announcements (# + 2 + 1 for Lynx panels or # + 0 + 2 + 1 for VISTA panels).

#### HOW TO REPLACE THE BATTERIES

- If the keypad is AC powered, unplug the AC transformer from the wall outlet.
- If the keypad is not wall mounted advance to step 3. If the keypad is wall mounted, perform the following:  
Grasp the keypad firmly. Lift straight up (about 1/4 inch) and then out, to separate the keypad from the mounting plate. This exposes the covered battery compartment on the backside of the keypad.
- Rest the inverted keypad on a non-abrasive surface and remove the battery compartment cover. Remove the old batteries and properly discard.
- Replace the old batteries with 3 AA, 1.5 Volt, Alkaline batteries (ADEMCO part number 468 or equivalent). Always replace all three batteries at once to ensure normal operation of the keypad over the anticipated battery lifetime. Make sure that battery positive (+) and negative (-) terminals are properly oriented with the battery spring clip connections. Refer to battery placement graphic below.

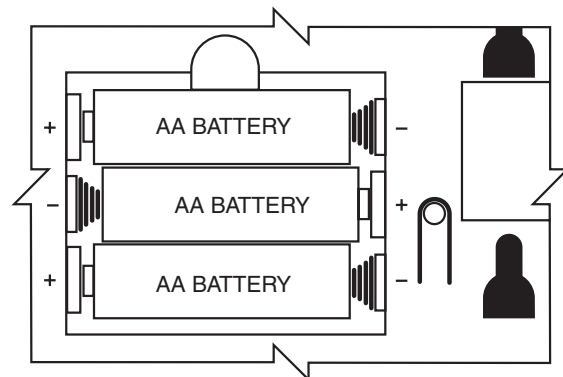

**Battery Compartment**

- Replace the battery cover.
- If the keypad is not wall mounted advance to step 7. If the keypad is wall mounted, perform the following:  
Reattach the keypad to its mounting plate by aligning the four mounting holes in the keypad case back with the four mounting clips on the mounting plate. Lower the keypad onto the clips.
- If the keypad is AC powered, plug the AC transformer into the wall outlet.
- Activate the keypad by pressing any numbered key until it beeps.
- Enter the following twice: your 4-digit security code + **1 OFF**, to clear any trouble condition displayed.

## GENERAL NOTES

- If the keypad is on battery power, it will go into battery-saver mode (become inactive) in 15 seconds with no key presses, even if exit delay is set to a longer time period.  
You would have to press the [\*] key to view (or hear) the new status of the security system.
- When arming in the MAXIMUM mode, the keypad will indicate "AWAY INSTANT." When arming in the INSTANT mode, the keypad will indicate "STAY INSTANT."

- Do **NOT** use the 5828/5828V to put the LYNX into Speaker Phone mode.
- There is no audio indication when you turn on or off lights (X10) using the 5828V.
- A wireless keypad low battery condition is displayed as "BAT" and "00" on the 5828/5828V keypad.
- Anticipated battery life of the keypad batteries is 1.5 years.
- Do **NOT** use the 5828V for silent panic operation because the keypad itself is not silent.

Your Honeywell security system is designed for use with devices manufactured or approved by Honeywell for use with your security system. Your Honeywell security system is not designed for use with any device that may be attached to your security system's keypad or other communicating bus if Honeywell has not approved such device for use with your security system. Use of any such unauthorized device may cause damage or compromise the performance of your security system and affect the validity of your Honeywell limited warranty. When you purchase devices that have been manufactured or approved by Honeywell, you acquire the assurance that these devices have been thoroughly tested to ensure optimum performance when used with your Honeywell security system.

## ONE YEAR LIMITED WARRANTY

Honeywell International Inc., acting through its Security & Custom Electronics business ("Seller"), 165 Eileen Way, Syosset, New York 11791, warrants its security equipment (the "product") to be free from defects in materials and workmanship for one year from date of original purchase, under normal use and service. Seller's obligation is limited to repairing or replacing, at its option, free of charge for parts, labor, or transportation, any product proven to be defective in materials or workmanship under normal use and service. Seller shall have no obligation under this warranty or otherwise if the product is altered or improperly repaired or serviced by anyone other than the Seller. In case of defect, contact the security professional who installed and maintains your security equipment or the Seller for product repair.

This one year Limited Warranty is in lieu of all other express warranties, obligations or liabilities. THERE ARE NO EXPRESS WARRANTIES, WHICH EXTEND BEYOND THE FACE HEREOF. ANY IMPLIED WARRANTIES, OBLIGATIONS OR LIABILITIES MADE BY SELLER IN CONNECTION WITH THIS PRODUCT, INCLUDING ANY IMPLIED WARRANTY OF MERCHANTABILITY, OR FITNESS FOR A PARTICULAR PURPOSE OR OTHERWISE, ARE LIMITED IN DURATION TO A PERIOD OF ONE YEAR FROM THE DATE OF ORIGINAL PURCHASE. ANY ACTION FOR BREACH OF ANY WARRANTY, INCLUDING BUT NOT LIMITED TO ANY IMPLIED WARRANTY OF MERCHANTABILITY, MUST BE BROUGHT WITHIN 12 MONTHS FROM DATE OF ORIGINAL PURCHASE. IN NO CASE SHALL SELLER BE LIABLE TO ANYONE FOR ANY CONSEQUENTIAL OR INCIDENTAL DAMAGES FOR BREACH OF THIS OR ANY OTHER WARRANTY, EXPRESS OR IMPLIED, OR UPON ANY OTHER BASIS OF LIABILITY WHATSOEVER, EVEN IF THE LOSS OR DAMAGE IS CAUSED BY THE SELLER'S OWN NEGLIGENCE OR FAULT. Some states do not allow limitation on how long an implied warranty lasts or the exclusion or limitation of incidental or consequential damages, so the above limitation or exclusion may not apply to you.

Seller does not represent that the product may not be compromised or circumvented; that the product will prevent any personal injury or property loss by burglary, robbery, fire or otherwise; or that the product will in all cases provide adequate warning or protection. Buyer understands that a properly installed and maintained alarm may only reduce the risk of a burglary, robbery, fire or other events occurring without providing an alarm, but it is not insurance or a guarantee that such will not occur or that there will be no personal injury or property loss as a result. CONSEQUENTLY, SELLER SHALL HAVE NO LIABILITY FOR ANY PERSONAL INJURY, PROPERTY DAMAGE OR OTHER LOSS BASED ON A CLAIM THE PRODUCT FAILED TO GIVE WARNING. HOWEVER, IF SELLER IS HELD LIABLE, WHETHER DIRECTLY OR INDIRECTLY, FOR ANY LOSS OR DAMAGE ARISING UNDER THIS LIMITED WARRANTY OR OTHERWISE, REGARDLESS OF CAUSE OR ORIGIN, SELLER'S MAXIMUM LIABILITY SHALL NOT IN ANY CASE EXCEED THE PURCHASE PRICE OF THE PRODUCT, WHICH SHALL BE THE COMPLETE AND EXCLUSIVE REMEDY AGAINST SELLER. This warranty gives you specific legal rights, and you may also have other rights, which vary from state to state. No increase or alteration, written or verbal, to this warranty is authorized.

### **FCC STATEMENT**

This device complies with Part 15 of the FCC rules. Operation is subject to the following two conditions: (1) This device may not cause harmful interference, and (2) This device must accept any interference received, including interference that may cause undesired operation.

# **Honeywell**

**165 Eileen Way, Syosset, New York 11791**

Copyright © 2004 Honeywell International Inc.

[www.honeywell.com/security](http://www.honeywell.com/security)



K0021V2 2/06 Rev. A

## Free Manuals Download Website

<http://myh66.com>

<http://usermanuals.us>

<http://www.somanuals.com>

<http://www.4manuals.cc>

<http://www.manual-lib.com>

<http://www.404manual.com>

<http://www.luxmanual.com>

<http://aubethermostatmanual.com>

Golf course search by state

<http://golfingnear.com>

Email search by domain

<http://emailbydomain.com>

Auto manuals search

<http://auto.somanuals.com>

TV manuals search

<http://tv.somanuals.com>