

LITEWAY™

Owner's Manual



401 Bridge Street • Old Forge, PA 18518 • Phone: 800-624-6374 • Fax: 800-628-5165 • www.goldentech.com

Owner's Manual and Service Record



Keep this manual in a safe place

This document contains the information required to familiarize yourself with the vehicle.

Complete all the information within this document.

If any information is not clear contact your Dealer immediately.

This document must remain with the vehicle throughout its use.

NOTICE

All Golden Technologies mobility products are sold through authorized dealers. Make sure your dealer demonstrates all the features of the product prior to or when it is delivered.

Contents

Introduction	4-5
Safety	6-9
Intended use	10
EMI	11
Controls – Dashboard	12
Controls – Driving controls	13
Controls – Dashboard description	14
Freewheel device	15
Freewheel device/brakes	16
Seat adjustment	17
Revolving seat	18
Tiller adjustment	19
Transporting the vehicle	20-23
Assembly of the transaxle	24
Battery charging.....	25-27
Simple maintenance.....	28
Troubleshooting guide.....	29
Additional safety information.....	30
Driving the vehicle.....	31
Diagnostics System.....	32
Driving the vehicle – hazards.....	33
Frequently asked questions	34
Additional information	35-36
Guarantee and Warranty	37
Servicing	38
Technician's checklist	39
Technical information regarding EMI	40
Technical specification	41
Warranty Card – dealer information	42

INTRODUCTION

Congratulations on the purchase of your new Golden Liteway™ scooter! The Liteway combines cutting edge technology with attractive designs that are also highly functional in today's world. We at Golden Technologies know that you have chosen a scooter that will give you years of dependable operation and will also enhance the quality of your life by providing you with the mobility to experience a more active daily lifestyle.

Please read, understand and follow all of the instructions and suggestions in this manual before you operate your Liteway for the first time. The safe use of your new scooter is very important and starts with you. Your new Liteway is user-friendly and designed for maximum maneuverability in even the tightest spaces.

If you feel uncomfortable with your new Liteway or do not understand the instructions presented in this owner's manual, or if, for any reason, you do not feel capable of performing the activities necessary to assemble, disassemble, operate, or maintain your Liteway, please contact the home health care dealer you purchased this scooter from or contact Golden Technologies Technical Support Services at 800-624-6374.

Golden Technologies, Inc. cannot be held responsible for personal injury or property damage resulting from the unsafe or the improper use of any of our broad range of health and personal mobility products.

Please fill out and mail the enclosed warranty registration card. We at Golden Technologies, would appreciate hearing about your experience with your new Liteway scooter!

Please mail your warranty card to:

Golden Technologies, Inc.
Warranty Registration Office
401 Bridge Street
Old Forge, PA 18518

Phone: 570-451-7477

Fax: 570-451-7494

Stop by our website 24 hours a day!!!

www.goldentech.com

INTRODUCTION

Your Golden Liteway™ is a battery-operated personal mobility vehicle. Please exercise caution and consideration when you are operating it. Driving your Liteway carefully and thoughtfully will help ensure your personal safety and the safety of other people.

Note: Before learning to operate your Liteway, have your Golden Technologies representative determine if it is advisable for you to practice getting on and off your Liteway and operating it in the presence of an attendant.

BEFORE GETTING ON YOUR LITEWAY

READ COMPLETELY AND UNDERSTAND THIS OWNER'S MANUAL BEFORE ASSEMBLING, OPERATING, TRANSPORTING, OR DISASSEMBLING YOUR GOLDEN LITEWAY.

- Check to be certain that the key is removed. See Operation section in this manual. This will eliminate the possibility of accidentally activating the thumb lever controls and causing injury to you or to others.
- Check to be certain that your Liteway brake handle is in the engaged position. See the Disassembly section in this manual.
- Flip up the armrests.

 **WARNING:** WHEN GETTING ON OR OFF YOUR LITEWAY, DO NOT PUT MOST OR ALL OF YOUR WEIGHT ON THE EDGE OF THE DECK. DOING SO MAY CAUSE THE SCOOTER TO TIP.

GETTING ON YOUR LITEWAY

- Make certain that the key is removed!
- Position the seat for safe and easy mounting. See Operation section.
- Carefully place one foot on the approximate center of the deck and seat yourself comfortably and securely on the seat.
- Fasten the lap belt, if your scooter is so equipped.
- Flip down the armrests.

GETTING OFF YOUR LITEWAY

- Make certain that the power is turned off and key is removed!
- Flip up the armrest.
- Unfasten the lap belt, if your scooter is so equipped.
- Carefully place one foot on the ground, transfer your weight to that leg, and slowly come to a standing position.
- Step away from the scooter.

MAXIMUM WEIGHT

Your Liteway has been rated to a maximum payload (includes operator and any other carry on baggage) of 300 pounds. Exceeding the maximum weight rating will void the warranty.

 **WARNING:** EXCEEDING THE MAXIMUM WEIGHT RATING MAY ALSO RESULT IN INJURY TO YOURSELF AND TO OTHERS.

Safety

DRIVING ON AN INCLINE

- For maximum stability, lean forward in your Liteway™ seat while proceeding up ramps, slopes, curbs, or any low rise.
- Drive with caution when attempting to negotiate any incline, even handicap access ramps.
- Always climb or descend a gradient by driving straight up or straight down the face of the slope.
- Do not traverse or drive across the face of a gradient.
- Do not attempt to negotiate an incline that is covered with snow, ice, cut or wet grass, leaves, or any other slippery material.
- Do not back down an incline.
- Try to keep your Liteway moving when climbing an incline. If you do come to a stop, restart and accelerate slowly and carefully.
- Do not try to descend or climb a slope whose gradient is greater than recommended. See Specifications section.

Max incline:
6°



WARNING: IF, WHILE YOU ARE DRIVING DOWN A SLOPE, YOUR SCOOTER STARTS TO MOVE FASTER THAN YOU FEEL IS SAFE, RELEASE THE THUMB LEVER AND ALLOW YOUR LITEWAY TO COME TO A STOP. WHEN YOU FEEL THAT YOU AGAIN HAVE CONTROL OF YOUR SCOOTER, PUSH THE THUMB LEVER FORWARD AND CONTINUE SAFELY DOWN THE REMAINDER OF THE SLOPE.

DRIVING DOWN AN INCLINE

- **Always** drive forward down any ramp, low rise, or incline.

Golden Technologies, Inc. does not recommend that you drive your scooter in reverse down any incline, ramp, curb, or low rise. Backing down any slope may create an unsafe situation.

Safety

RULES FOR USE AND OTHER SAFETY CONSIDERATIONS

MEDICATION

Always check with your physician to determine if any of the medications you are taking may affect your judgment and / or your ability to operate your Liteway™. Also check with your physician concerning your physical ability to operate a scooter.

 **WARNING: DO NOT CONNECT OR ALLOW ANYONE EXCEPT AN AUTHORIZED GOLDEN TECHNOLOGIES REPRESENTATIVE TO CONNECT ANY ELECTRICAL OR MECHANICAL DEVICE TO YOUR LITEWAY. UNAUTHORIZED ACCESSORIES WILL VOID THE WARRANTY AND MAY CAUSE INJURY.**

Note: Please remember that while on your Golden Liteway, you are a motorized pedestrian. You must observe and obey all pedestrian rules and regulations for the locale in which you are riding.

Please use your Golden Liteway scooter often and allow it to expand the horizons of your daily life. But as with all things, especially motor operated vehicles, observing a few rules and safety considerations will help ensure safe scooter operation. So please follow the rules below.

- Do not turn your scooter while on an incline or decline.
- Always keep all of your body parts within the confines of the scooter.
- Do not hose down your scooter.
- Always remain properly seated when operating your scooter.
- Do not place your scooter in freewheel mode when on an incline or decline.
- Never sit on your scooter when it is in freewheel mode.
- Always reduce the speed of your scooter when making turns.
- Do not operate or store your scooter where it will be exposed to rain, snow, mist, and below freezing temperatures.
- Do not operate your scooter on slippery, icy or salted surfaces.
- Never charge a frozen battery.
- Do not modify your scooter in any way that is not authorized by Golden Technologies.

Safety

RULES FOR USE AND OTHER SAFETY CONSIDERATIONS

- Read completely and understand this owner's manual before assembling, operating, transporting, or disassembling your Golden Liteway™.
- Always operate your Golden Liteway with thought, care and safety.
- Do not attempt to use your Liteway on an escalator. Always use in an elevator.
- Do not carry passengers under any circumstances.
- Do not mount or dismount your Golden Liteway unless the brake is engaged.
- Make certain that the key is removed before mounting or dismounting your scooter.
- Do not back your Golden Liteway down an incline or across an uneven surface.
- Make certain that the seat is locked in the forward position before operating your Liteway.
- Always come to a full stop before changing direction from forward to reverse or from reverse to forward.
- Do not operate your Liteway where you could not safely or legally walk.
- Do not climb ramps or curbs that exceed your scooter's capacity.
- Always approach curbs and inclines straight on.
- Be aware of and careful near mechanical pinch points (for example, when mating rear carriage to the front frame, especially when assembling and disassembling your scooter. See Assembly/Disassembly section.
- Never sit on your Liteway when it is being transported.
- Do not operate your vehicle if it is not functioning properly.
- Use caution when driving on soft or uneven surfaces such as grass and gravel.
- Also use caution on decks where there is no railing.
- Never drive on the roadway, except when you must cross the street.
- Never back up or down a step or curb.
- Never operate your Liteway while you are under the influence of alcohol.

 **WARNING: TURNING TOO SHARPLY AROUND A CORNER CAN CAUSE THE SCOOTER TO TIP. AVOID THIS DANGER AT ALL TIMES BY STEERING A WIDE ARC AROUND CORNERS AND OBSTACLES. ALSO, TO AVOID THE RISK OF TIPPING, REDUCE SPEED BEFORE NEGOTIATING ANY TURNS.**

For emergency stopping, turn off scooter key – scooter will stop.

Safety Information

Read this manual thoroughly before driving or operating the vehicle.

Every mobility scooter operates differently. Do not assume they are the same. If you have any doubt about the content of this manual contact your dealer immediately.

Read the instructions contained within this document, maintain the vehicle and ensure it is serviced regularly.

Within this manual there are important safety notices. They are clearly marked on the appropriate pages. Make sure that you understand these notices. If you have any doubt contact your dealer.

© 2006 Golden Technologies, Inc.

No liability is assumed with respect to the use of any information contained in this publication. While every precaution has been taken in the preparation of this publication Golden Technologies assumes no responsibility for errors of omissions nor is any liability assumed for damages resulting from the use of information contained in this publication. This publication, as well as the operational details described herein, is subject to change without notice.

Intended Use

Intended use of the vehicle

This vehicle is designed to help any person that is capable of driving a motorized scooter (up to the maximum recommended weight) who requires a lightweight scooter that can be transported in the trunk of a car.

To achieve compact dimensions requires small wheels and these are not suitable for climbing large curbs or obstacles – see manual for further information.

Safety Information

Information Regarding Electromagnetic Interference (EMI)

This section contains information on the possible effects of electromagnetic interference to your vehicle.

EMI refers to the effects electromagnetic energy might have on the control systems of your vehicle. The interference could cause the brakes to release, the vehicle to move by itself or damage the electronics.

There are generally three types or sources of electromagnetic energy:

1. Hand held, short range portable transceivers. Examples include: CB radios, walkie-talkies, security, fire and police transceivers, cellular phones and other devices that transmit a signal even when not in use.
2. Medium range mobile transceivers. Examples include: police, fire, ambulance and taxi transceivers.
3. Long range transmitters and receivers. Examples include: radio and television towers and amateur (HAM) radios.

There is an immunity level that has to be met by law and your scooter has been tested to the required level. For a full technical explanation see page 39 in this document.

WARNING

Even though your vehicle meets the requirements it is recommended that you follow certain precautions.

1. Do not operate hand held transceivers such as CB radios or mobile phones while the vehicle is switched on.
2. Be aware of transmitter towers, such as television and radio stations. Avoid getting close to them.

If your vehicle starts to operate by itself switch it off and call your dealer.
Report all faults of this type to Golden Technologies.

Liteway™ Operation

Before driving your vehicle it is important to familiarize yourself with the controls.
Do not attempt to drive the vehicle before reading the rest of this manual.



Controls – Driving Controls/Accelerator

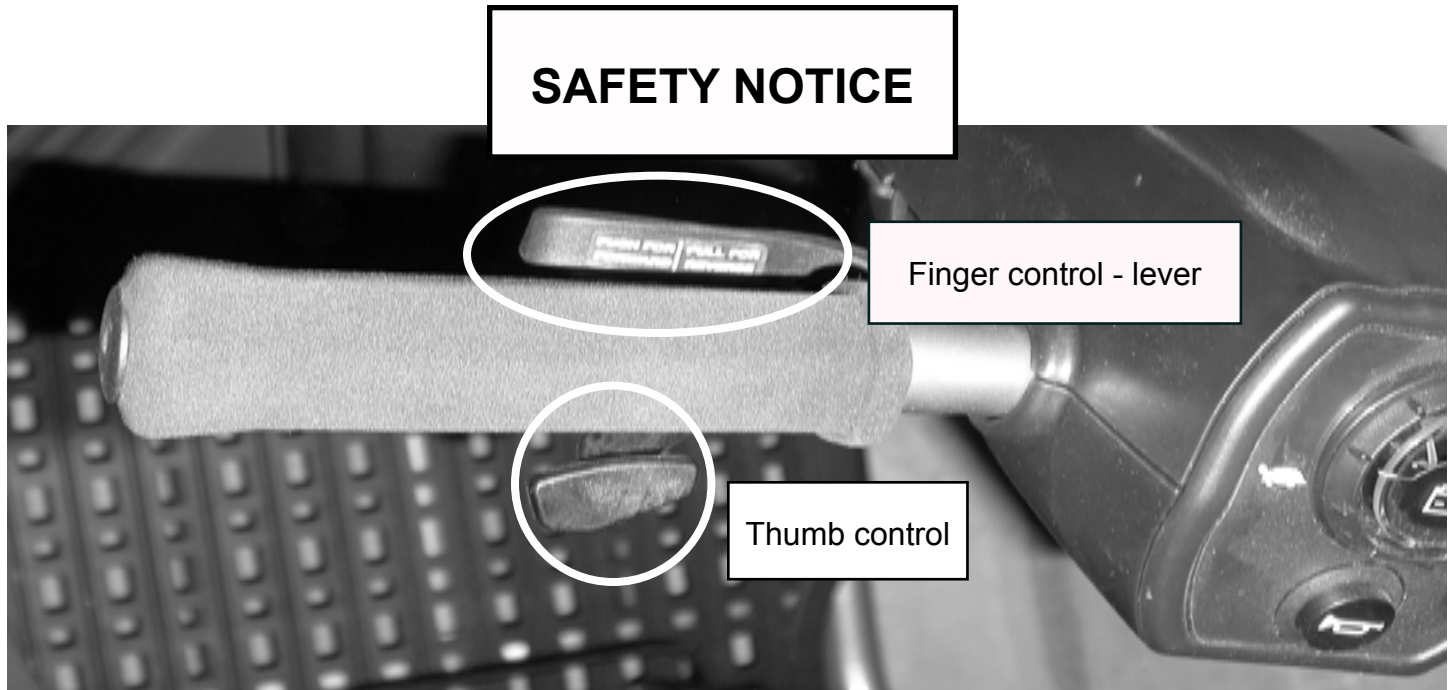

Photo shows thumb actuators fitted.

Finger/Thumb control

The Liteway™ is equipped with the unique feature of finger/thumb control. This allows you to operate the accelerator using either your thumb or finger, whichever is more comfortable.

To operate, turn on the ignition.

Finger Control: pull in the right hand lever and the machine moves forward. The more you pull the lever the faster the scooter goes. To brake, release the lever. Again the faster the lever is released the quicker you will stop. To reverse, pull in the left lever. Do not pull both levers at once.

⚠ CAUTION:

Thumb Control (optional): forward/reverse controls are reversed. Right hand side is reverse and left hand side is forward.

Dashboard Controls/Description

Description of Dashboard Controls

Battery Indicator: This instrument shows the level of charge in the batteries. When in the green area the batteries are fully charged. When in the yellow area the batteries need recharging and when in the red area the batteries **urgently** need recharging. Note: When the vehicle is climbing a steep incline or starting off, the level may drop momentarily, this is normal.

Red indicator lamp: When the ignition is switched on a red light appears in the left hand corner of the battery indicator. When the light is constant the vehicle is ready to go. If the light flashes there is a problem. The lamp will flash if the accelerator lever is pulled in at the same time you in switch on the ignition or the vehicle is in freewheel (see pages 15 & 16). Check to see if the freewheel is engaged, turn off the ignition and switch it on again. The lamp should show a stable light. If it stills flashes contact your dealer.

Speed Control Dial: This controls the top speed of your scooter. It is located on the outer part of the battery indicator. When the dial is turned to the left, this is its slowest speed. As the dial is turned to the right the speed will increase to a maximum, which is the highest speed. Set the speed before you move off. Do not adjust when the vehicle is moving.

Horn: Press the button and the horn will sound. Release and the horn will stop.

Ignition Switch: Always remember to remove key **when not in use**. Do not leave the ignition on when not in use especially when charging the vehicle.

Freewheel Device

SAFETY INFORMATION

When the vehicle is switched off the brakes are automatically engaged. This is called “failsafe braking”. If the batteries are flat, the same thing happens.

There may be occasions where you may wish to move the vehicle without power. To do this there is a freewheel device fitted.

The freewheel device allows the vehicle to be pushed without power. To activate, first locate the lever. It is located on the right hand side of the rear of the vehicle when standing behind it (red lever). Please see page 16

- **Make sure the ignition is switched off.**
- **Move the lever forward. The vehicle can now be pushed in freewheel mode.**
- **Move the lever back to engage. The brake is now engaged – this is the normal operating position.**
- **IF YOU ARE NOT COMPLETELY SURE OF THIS FEATURE CONTACT YOUR DEALER BEFORE OPERATING THE SCOOTER.**

Freewheel Device/Brakes

SAFETY INFORMATION

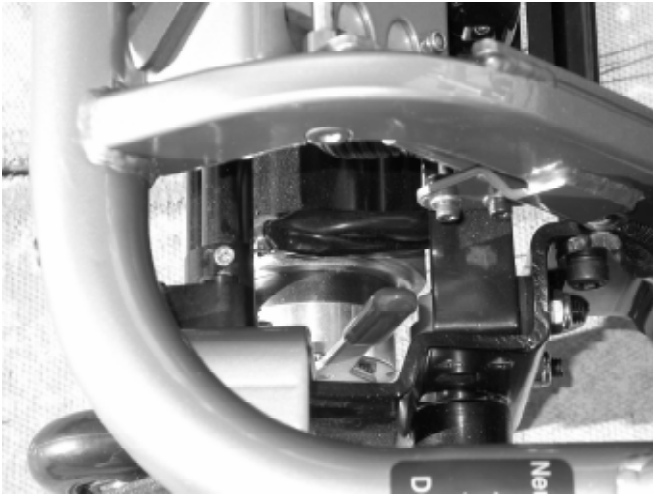

Push the lever forward to enable the vehicle to be moved without power. NEVER sit on the vehicle with the lever in this position.

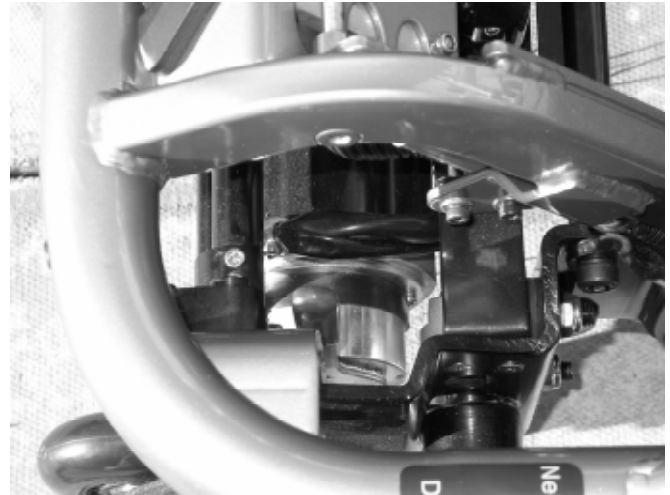

Pull the lever back to the upright position. The brake is in the ON position. This is the normal operating position and the vehicle will only operate with the brake on.

Brakes

There are two braking systems. The first works with the accelerator. When the accelerator is released the scooter will automatically brake and bring the scooter to a stop. When the scooter stops the automatic handbrake will engage. This will stop the vehicle from rolling forward or backward. When you start the scooter the handbrake will automatically disengage. If the battery should lose power, the brakes automatically engage.

Seat Adjustment



Armrest Adjustment

When getting seated on the scooter lift the arm rest up. When riding always have the armrest in the down position.

If you require more room in the width of the seat undo the black knobs as shown. Slide the armrests in or out to suit. Tighten both knobs to clamp. (One on each armrest)

Check the knobs for tightness twice a week.

Swivel Seat

Optional swivel seat

This option allows easy access on and off the vehicle.

1. To operate locate the release lever under the seat.
2. Push the lever forward as shown and the seat will release allowing it to rotate.
3. Release the lever and the seat will lock automatically.

Warning

1. Do not use this device if the vehicle is on a slope.
2. Always check that the seat is locked in the forward position before driving the vehicle.



Tiller Adjustment

The tiller adjustment, sometimes known as the handlebar adjustment, allows you to alter the angle of the tiller to suit your driving style or to fold the tiller down for transporting.



Fully folded for transportation or storage



Locate the black knob at the base of the steering column.

With one hand hold the tiller while unscrewing the clamp.

The tiller is now free to move. Move the tiller to the desired position and tighten the clamp. As you tighten the clamp gently rock the tiller back and forth. This allows the teeth on the clamp to engage correctly. **Check the clamp daily to ensure it is tight.**

Transporting Your Scooter

To transport your scooter you may need to dismantle it. Follow these step by step instructions



Step 1: Preparation

1. Turn off the ignition and remove key.
2. Fold down the backrest and lift off the seat.
3. Pull the seat upwards and it will release.
4. When assembling the seat make sure the seat is located correctly then turn until it locks.

Step 2: Tiller

1. Fold the tiller as shown on page 19. You can remove the under seat basket or leave it in position.
2. The under seat basket is retained with magnets. To remove grab the basket handle and pull out.
3. To replace, locate into the same position and push in until you feel the magnets locate.

Transporting Your Scooter



Step 3 – Retaining Strap

The retaining strap stops the steering column from moving around when transporting or assembling the scooter. Wrap the Velcro® strap around the handlebars as shown.



Step 4: Remove the Battery

To remove the battery (black box located at the rear of the scooter), pull the handle upwards and this will release the lock automatically. The battery will slide out. Remove the battery completely.

Be careful this part will be heavy.

Transporting The Vehicle



Step 5: Removing the transaxle or rear wheels

To make the vehicle lighter for lifting it is possible to remove the transaxle or rear wheel assembly. At the rear of the vehicle are two bars. Locate the lower bar and pull it towards you. This releases the lock. With your other hand lift the frame out of the assembly (circled).

Transporting The Vehicle

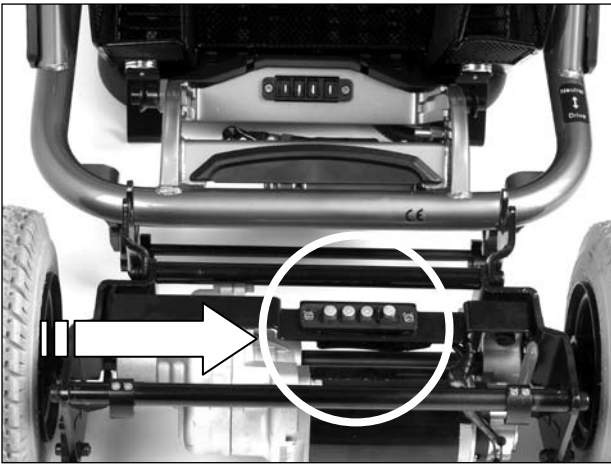

The transaxle is now separated from the frame.

When lifting the unit use the bar to lift (arrowed). Be careful this part is heavy.

Make sure the contacts are not damaged (circled).



The vehicle is shown fully dismantled for transportation.

Assembly of the Transaxle or Rear Wheel Assembly

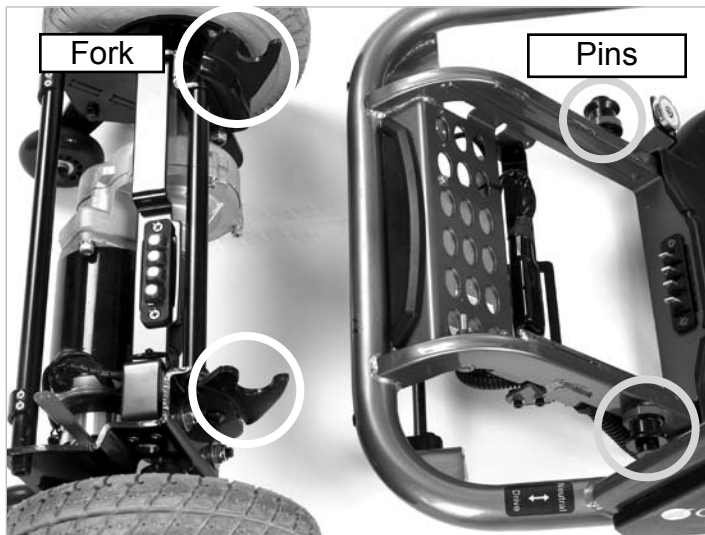

When assembling the vehicle after transporting first assemble the transaxle or rear wheel assembly. Place the assembly as shown next to the frame. The fork has to locate into the pins as shown.

The pins are marked in red.

Lift the frame over the forks. Line up the pins and lower the frame. When both sets are located push the frame down. You will hear a “click” as the assembly locks. If the transaxle is not located correctly the vehicle will not operate.

SAFETY NOTICE

Assemble the remaining sections in reverse order of dismantling.

Battery Charging



The charging socket is located in the rear of the battery box. Slide away the protective cover and push in the round silver plug. When the vehicle is charged remove the plug check the protective cover is set in the closed position. This keeps water out.

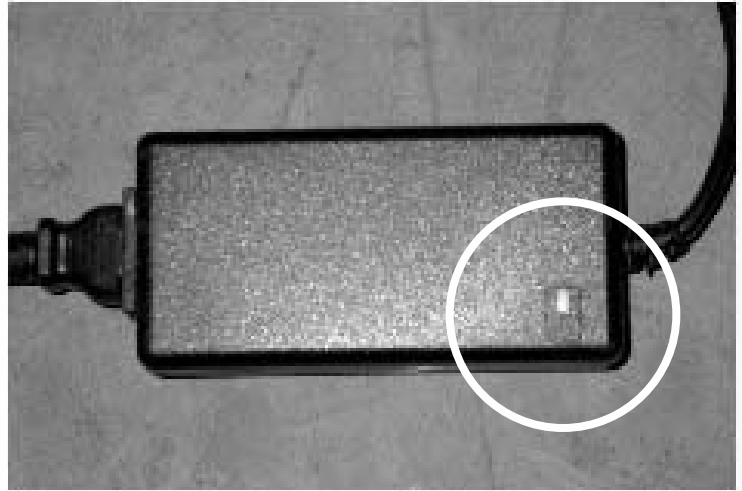

The battery charger has a small LED light as shown. When the charger is connected and switched on it will show a red lamp. When the battery is charged the LED light will change to green.

Battery Charging

Correct battery charging prolongs the life of your batteries.

Connection Instructions

When you receive your vehicle the batteries are only partially charged – fully charge before use preferably over night.

1. Place your machine in an area that is dry and well ventilated. Make sure a 110/120 volt outlet is nearby.
2. Check that the vehicle is **switched off and the key removed.**
3. Check that the main switch is off. **Never connect or disconnect the charger with the main switch on.**
4. Connect the charger to the battery (page 25).
5. Connect the plug and switch on the charger.
6. The power illuminates red when switched on. The charger light changes to green when charged.
7. Turn off the main switch and remove the plug from the battery when fully charged. Do not leave the charger plugged in with the power off. This will discharge your battery.

You can charge your battery on or off the vehicle. To remove the battery see page 21.

Charging Batteries

The batteries are the lifeblood of your vehicle. Their characteristics can change depending on charging, temperature, usage and other factors. Listed below are guidelines to prolong their life.

Charging Your Batteries

1. After using your vehicle always charge it at the end of the day even after a short journey.
2. If you do not use your vehicle for a prolonged period, place it on charge once a week, overnight.
3. Always use the correct charger with the correct batteries.
4. If the batteries have been flat for a long time (about two months) it is recommended you contact your dealer before charging.
If one or both batteries are damaged they could heat up when charging or in an extreme case explode.
5. Do not charge the vehicle outdoors – it may rain and the battery charger is not waterproof.
6. Keep the vehicle in a well-ventilated area and away from any open flame.
7. Do not force the plug into the charging point (page 25). Push it lightly in and turn the plug until the pins line up, then push in fully.
8. Do not partially charge the batteries. Allow the charger to complete its cycle.

These items are expensive to replace – look after them.

Simple Maintenance

A qualified technician should perform all necessary maintenance.

Unfortunately they cannot be there at all times. Items you should check on a daily/weekly basis:

Daily

1. Visually check the machine for damage.
2. Visually check the tires for damage. The tires are maintenance free and do not require inflating.
3. Check the steering column moves freely.
4. Tiller clamp is tight.
5. Seat is located correctly and locked.
6. Check the armrests are tight (page 1).
7. Batteries should be fully charged.
8. Under seat basket is secure.

Important – Possible Faults

As you get used to your vehicle you will get a feel for how it behaves. If something feels unusual, for instance the vehicle does not accelerate or brake smoothly; the brakes are not holding on a slope or the steering feels different, contact your dealer immediately and explain to the technician exactly what the problem is. This will help diagnose the problem.

Troubleshooting Guide

**This table is a guide to fault finding. The fault may be a simple fix.
If you have any doubts contact your dealer.**

Symptom	Solution
<ul style="list-style-type: none"> Unit does not move. Check: Does the battery level indicator work when the ignition is switched on? 	<ul style="list-style-type: none"> Freewheel is engaged. (page 16. Batteries flat – check level. (page 14).
<ul style="list-style-type: none"> Steering is loose when driven. Check: Have you hit a curb or obstacle hard? Are the handlebars straight when riding in a straight line? 	<ul style="list-style-type: none"> Check for tire damage. Damaged steering - contact dealer. Loose seat - contact dealer.
<ul style="list-style-type: none"> Vehicle behaves erratically when driven. Check: Does the vehicle shudder or cutout. 	<ul style="list-style-type: none"> Possible electronic problems - contact dealer.
<ul style="list-style-type: none"> Short range Check: If the red charging lamp stays on after all night charging (page 27) it could be a defective battery. 	<ul style="list-style-type: none"> Binding front wheels. Binding rear wheel - emergency brake. Switch into freewheel and the vehicle should move easily (page 16). If not contact dealer.

Additional Safety Information

Carrying Weight on the Vehicle

Handlebars – Do not carry or attach anything to the handlebars. Anything attached to the handlebars will affect the control of the vehicle.

Floor Area – Use the under seat basket for storage only. Do not use the floor area.

Other Items – Only fit approved products or accessories.

Child Safety

This product is designed to be operated by adults. Children should not be allowed to tamper with the controls or play on the vehicle.

Do not carry children as passengers.
The product is designed for single person use only.

Keep all packaging well away from children.

Driving The Vehicle

Read this before driving the vehicle!

Whether or not this is your first mobility vehicle, read these guidelines as all vehicles differ. Failure to do this may cause damage to yourself, a third party or the vehicle.

1. Check the weather forecast. Make sure you are wearing suitable clothing, whether your journey is long or short.
2. If you are taking medication check with your doctor or physician that your ability to control the vehicle will not be impaired.
3. Do not drink alcohol and drive – it's the law!
4. Only use the vehicle for the purpose it's intended for. Do not drive through deep water; transport more than one person; tow other vehicles, or carry excess weight. Do not modify the vehicle as this will render your warranty void.
5. Check the freewheel lever is in the locked position (page 16)
6. Check the battery charger is disconnected.
7. Check you have adjusted the seat as instructed in this manual – get comfortable – set the speed control dial to a low setting (page 12).
8. Make sure the road ahead is clear.
9. Switch on the vehicle (page 12). Check the battery level indicator is in the green area (page 12).
10. Pull in right hand lever slowly (page 13). The vehicle will now move. The more you pull the lever in the faster the vehicle will go.
11. To brake, release the lever. If you become unsure or feel unsafe release the lever immediately.
12. As you get accustomed to the power you can increase the speed.

Diagnostics System

Any fault condition of the controller or scooter will cause the "Power on/diagnostics" LED to flash. The LED light located on the faceplate of the scooter will tell you about the problem in how it flashes.

LED Flashes 1 time, pause, 1 time, and pause. Battery needs recharging or bad connection with battery.

LED Flashes 2 times, pause, 2 times, pause. Bad motor connection. Check all connections between controller and motor.

LED Flashes 3 times, pause, 3 times, pause. Short circuit between motor and battery connection. Contact authorized service facility.

LED Flashes 4 & 5 times. (Not Used)

LED Flashes 6 times, pause, 6 times, pause. Controller inhibited from operation. Disconnect battery charger.

LED Flashes 7 times, pause, 7 times, pause. Throttle fault. Engager levers must be in neutral (centered) position before vehicle is turned on. Paddle fault and speed pot fault. Switch vehicle off center levers and switch back on.

LED Flashes 8 times, pause, 8 times, pause. Controller fault. Check all connections.

LED Flashes 9 times, pause, 9 times, pause. Bad parking brake connection. Check parking brake and motor connections.

LED Flashes 10 times, pause, 10 times, pause. Excessive voltage detected at controller. Check battery connections.

Flashing LEDs. Controller has entered Sleep mode. Cycle Key Off/ On to reset.

Driving The Vehicle – Hazards

Read this before driving the vehicle

Failure to do this may cause damage to yourself, a third party or the vehicle.

Getting on and off the vehicle: Stop the vehicle on a flat area. Turn off the ignition and remove the key. Make sure you get off the vehicle in a safe area.

Curbs and Obstacles: Do not ride up curbs or obstructions higher than 1". On any inclines make sure you lean forward. This places more weight over the front making the vehicle more stable.

Hills and Slopes: Lean forward when going up. Make sure you have enough speed to make the slope. Do not stop or turn the vehicle around. If you have to turn while climbing an incline keep going until you reach a level area. If you have to start on an incline lean forward and apply power slowly – do not start and stop. Always check the battery level is high. If the level drops too low the vehicle will cutout leaving you stranded.

Lean back in the seat when going forward downhill, and turn the speed control dial to low (page 12).

Do not drive across a slope at an angle – always drive straight up and down the slope.

NEVER BACK DOWN A SLOPE!

Turning: Slow down and look in the direction you are travelling – if it's a blind corner sound the horn.

Bad Weather: If its snowing or icy stay at home! Remember that ice, snow and slippery surfaces such as manhole covers, wet grass and drains could affect braking and steering. Use caution at all times.

Frequently Asked Questions

How do I clean the vehicle?

Use a sponge and soapy water. Rinse off with water. Do not use a hose.

What happens if I have a problem with the vehicle?

With any problem you will have to call your dealer.

Your dealer is there to help you but they can only do this if you give them as much information as possible. Remember correct information will get the problem fixed quicker and save you money. Call the dealer and explain exactly what the problem is. Remember small points help the technician to identify the problem before he calls to fix it.

I want to transport my vehicle but the truck is too high for me to lift the vehicle.

There are various techniques to loading the vehicle into a car. It depends on what type of vehicle you own. Make sure your dealer has demonstrated the easiest way of doing this.

Can I fit weatherproofing such as a canopy?

Yes, but remember if you alter the vehicle in any way it will void your warranty. Be aware that enclosed canopies can affect the handling of the vehicle in strong winds.

Additional Information

How long will my batteries last and what range can I expect?

Battery life and range depend on many things but a rough guide to batteries are:

- Keep them charged, do not let the batteries run completely flat. If they are flat charge them up.
- The life of a battery depends upon the number of cycles the battery goes through.
- If you carry out these simple instructions your batteries will have a longer life.

Range can be affected by many things such as:

- Temperature.
- Faulty or worn batteries.
- Faulty charger.
- Type of terrain.
- Weight of the person.

Important rule: Always use the correct charger with the correct batteries.

How long should I keep my vehicle before I change it?

Keep it as long as it suits your needs. Remember vehicles of any type become more expensive to maintain the older they get.

Additional Information

If you lose your Owner's Manual replacement copies are available from:

Golden Technologies
401 Bridge Street
Old Forge, PA 18518
Telephone: 800-624-6374

If in doubt contact the dealer.

For Information regarding other Golden Technologies products contact your dealer or log on to the Golden Technologies Website www.goldentech.com

Warranty

Lifetime Warranty

The lifetime warranty includes the structural frame components listed below.

- Main metal frame
- Rear frame
- Fork
- Seat post
- Frame welds

Two Year Warranty

The following parts are covered by Golden Technologies two year warranty

- Battery charger
- Controller

One Year Warranty

- Drive train

This warranty excludes the following parts:

- Batteries*
- Tires*
- ABS plastic shrouds.
- Damage caused by abuse, misuse, accident or negligence, improper operation, maintenance or storage. Commercial use or use other than the products original purpose. Repairs and/or modifications made to any part without consent from Golden Technologies.
- Labor, service calls, shipping, and other charges incurred in repair of the product unless specifically authorized by Golden Technologies. This warranty does not include any labor charges incurred in replacement part installation.

Implied warranties, including those of merchantability and fitness for a particular purpose, are excluded. Liabilities for consequential damage are excluded.

This warranty gives you specific rights and you may also have other rights, which vary from state to state.

To obtain warranty parts and service, you must have a warranty registration card filed with Golden Technologies. Contact your Golden Technologies authorized dealer for service.

The warranty period commences on the purchase date from the seller/dealer. If the product is rented or otherwise not sold to the consumer, the warranty commences on the invoice date from Golden Technologies.

**Warranty from original vendor may apply*

Servicing

This section covers maintenance.

1. This vehicle is designed for minimum maintenance. However it is recommended that a competent technician service the vehicle once a year. If the vehicle is used constantly we recommend a twice yearly maintenance.
2. Make sure the technician stamps this manual on completion for all servicing carried out on this vehicle. Keep all receipts for servicing and repairs with this handbook. This may add value when selling the vehicle.
3. When the vehicle is due for its annual service make sure you report any concerns you have preferably when you book the service (see points to look out for below).
4. On completion of the service, always test the vehicle before the technician leaves and make sure you are satisfied with the work carried out.

Points to look out for:

- Are there any strange noises from the wheels or does the frame creak when going over rough ground?
- Are the batteries charging up correctly – is the full charge light coming on after charging?
- Is the steering tight or is it loose when turning? Is there any play in the steering?
- Has anything come loose?
- Does the vehicle perform as well as it did when it was new?
- Are there noises or rattles that were not there before?

Technician's Checklist

CHECKLIST

- Initial diagnostic road test
- Wheel bearings wear and lubricate
- Wheel alignment
- Speed dial works correctly
- Wear or damage to tires or wheels
- Bodywork fixtures
- Throttle play and adjustment
- Battery box contacts and release mechanism
- Steering bearing (adjust as required)
- Seat mounting
- Revolving seat mechanism locates correctly
- Transaxle mountings are tight
- Handlebar alignment
- Motor brush wear
- Motor speed check
- Transaxle play
- Electromagnetic brake operation
- Freewheel operation
- Frame for damage or cracks
- General corrosion
- All operational controls work correctly
- Battery condition and charger operation
- Tighten all nuts and bolts
- Final road test
- Clean vehicle
- Customer road test



Important Note for the Technician

Ask if the customer is satisfied with the product.
Please report all comments directly to:

Golden Technologies, Technical Services
Telephone: 800-624-6374

If you have any comments please include them.

Technical Information Regarding EMI

Important Technical Information Regarding Electromagnetic Interference (EMI)

The intensity of interference from electromagnetic energy is measured in volts per meter (v/m), which refers to the strength of the electrical source (voltage) as it relates to the distance away from the object being considered (in meters). Resistance of a scooter/wheelchair to certain EMI intensity is commonly called its "immunity level". 20 volts/meter is a generally achievable and useful immunity level against interference from radio wave sources (the higher the immunity level, the greater protection).

Your scooter has been tested and found to meet the required immunity level from Electromagnetic Interference (20v/m): the intensity of interference from electromagnetic energy.

 **WARNING:** Even with the immunity level of 20 volts/meter, certain precautions must be followed to ensure your scooter/wheelchair will not be affected by outside electromagnetic sources. See page 11 of this manual for additional information.

Technical Specification

Model:	GL-100
Length:	41"
Width:	22"
Tires:	Foam-filled non-pneumatic
Front Tire:	7"
Rear Tire:	9"
Weight Capacity:	300 lbs
Max Speed:	4 mph
Ground Clearance:	3"
Turning Radius:	32"
Seat Weight:	21 lbs.
Battery Pack Weight:	19 lbs.
Front Half Weight:	39 lbs.
Rear Half Weight:	25 lbs.
Total weight including batteries:	104 lbs.
Freewheel Mode:	Yes
Electronic Speed Control:	Yes
Brakes:	Electro mechanical
Charger:	Off-board
Rear-wheel Drive:	Sealed transaxle motor, 24V DC
Controller:	45 amp programmable
Warranty - frame:	Limited lifetime
Warranty - electronics:	2 years
Warranty - drive train:	1 year

Scooter Warranty Card

Please mail this document to:
Golden Technologies, Inc.
Warranty Registration Office
401 Bridge Street
Old Forge, PA 18518

Please fill in your Liteway™ information below. This information will be useful in the event that you ever need to contact Golden Technologies concerning your scooter.

Model _____ Serial Number _____

Date of Purchase _____ Body Color _____

Options _____

Your Golden representative or dealer

Name _____

Company _____

Address _____

Please indicate your understanding of your Golden Liteway by completing the following information.

_____ I have read and fully understand:

_____ My Golden Liteway owner's manual, especially the sections on operating instructions, safety guidelines, maintenance and battery instructions.

_____ Liteway Warranty

_____ My Golden Liteway dealer has instructed me on how to operate my scooter.

Signature _____

Telephone (_____) _____ - _____

LITEWAY™

Owner's Manual



401 Bridge Street • Old Forge, PA 18518 • Phone: 800-624-6374 • Fax: 800-628-5165 • www.goldentech.com

Free Manuals Download Website

<http://myh66.com>

<http://usermanuals.us>

<http://www.somanuals.com>

<http://www.4manuals.cc>

<http://www.manual-lib.com>

<http://www.404manual.com>

<http://www.luxmanual.com>

<http://aubethermostatmanual.com>

Golf course search by state

<http://golfingnear.com>

Email search by domain

<http://emailbydomain.com>

Auto manuals search

<http://auto.somanuals.com>

TV manuals search

<http://tv.somanuals.com>