

Through Hole Power Inductors

THAR0806 Type

Features

- RoHS compliant.
- High current (I_{sat} up to 40A) through hole type.
- Magnetically shielded, suitable for high density mounting.
- High energy storage and low DCR.
- Ideal for power source circuits, DC-DC converter, DC-AC inverters inductor application.
- In addition to the standard versions shown here, customized inductors are available to meet your exact requirements.

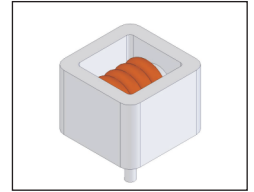

Mechanical Dimension:

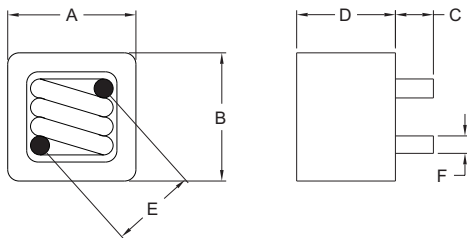

RECOMMENDED PAD PATTERNS

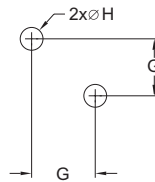

UNIT : mm/inch
 A = 8.20 / 0.323 Max.
 B = 8.20 / 0.323 Max.
 C = 3.50 ± 0.5 / 0.138 ± 0.020
 D = 6.00 / 0.236 Max.

Electrical Characteristics : At 25°C: 100KHz, 1V

PART NO.	L^1 (μH)	DCR ($\text{m}\Omega$) $\pm 8\%$	I_{sat}^2 (A dc)	I_{rms}^3 (A dc)	$E \pm 0.5$ (mm/inch)	$F \pm 0.1$ (mm/inch)	$G \pm 0.5$ (mm/inch)	H Max. (Mm/inch)
THAR0806-R47	0.47	2.6	34	19	6.3 / 0.248	0.8 / 0.031	4.5 / 0.177	1.2 / 0.047
THAR0806-0R6	0.60	2.6	30	19	6.3 / 0.248	0.8 / 0.031	4.5 / 0.177	1.2 / 0.047
THAR0806-0R8	0.80	3.0	27	18	6.3 / 0.248	0.8 / 0.031	4.5 / 0.177	1.2 / 0.047
THAR0806-1R0	1.00	4.7	22	15	6.3 / 0.248	0.7 / 0.028	4.5 / 0.177	1.1 / 0.043
THAR0806-1R2	1.20	4.7	21	15	6.3 / 0.248	0.7 / 0.028	4.5 / 0.177	1.1 / 0.043
THAR0806-1R5	1.50	6.0	15	12	6.8 / 0.268	0.6 / 0.024	5.0 / 0.197	1.0 / 0.039
THAR0806-1R8	1.80	10.4	14	10	6.8 / 0.268	0.5 / 0.020	5.0 / 0.197	0.9 / 0.035
THAR0806-2R0	2.00	10.4	12	9	6.8 / 0.268	0.5 / 0.020	5.0 / 0.197	0.9 / 0.035
THAR0806-2R5	2.50	11.5	10	8	6.8 / 0.268	0.5 / 0.020	5.0 / 0.197	0.9 / 0.035

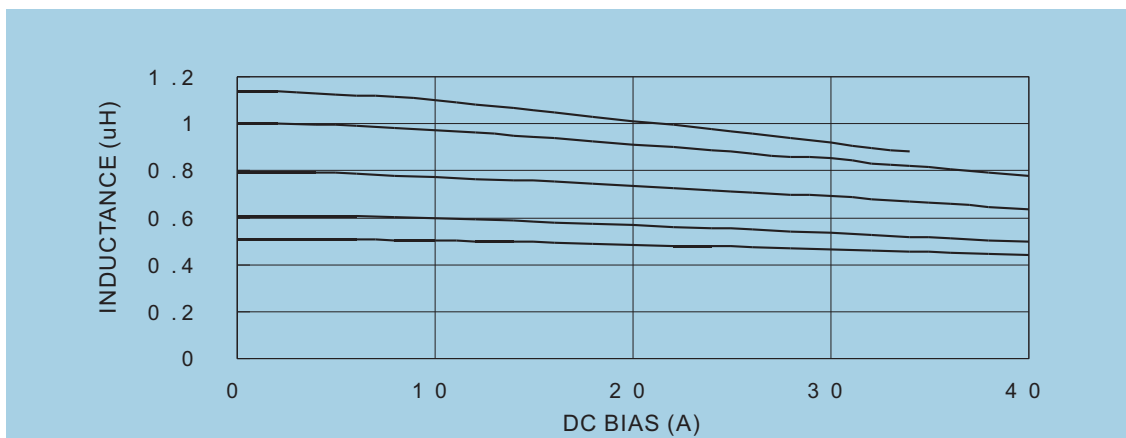

1. L_0 is the initial inductance and the tolerance is $\pm 20\%$.
2. I_{sat} is the DC current which cause the inductance drop less than 20% of its nominal inductance without current.
3. I_{rms} is the DC current which cause the surface temperature of the part increase approximately 45°C.
4. Operating temperature : -40°C to 125°C (including self-temperature rise).



DELTA ELECTRONICS, INC.

(TAOYUAN PLANT CPBG) 252, SAN YING ROAD, KUEISAN INDUSTRIAL ZONE, TAOYUAN SHIEN, 333, TAIWAN, R.O.C.

TEL: 886-3-3591968; FAX: 886-3-3591991

<http://www.deltawww.com>

Free Manuals Download Website

<http://myh66.com>

<http://usermanuals.us>

<http://www.somanuals.com>

<http://www.4manuals.cc>

<http://www.manual-lib.com>

<http://www.404manual.com>

<http://www.luxmanual.com>

<http://aubethermostatmanual.com>

Golf course search by state

<http://golfingnear.com>

Email search by domain

<http://emailbydomain.com>

Auto manuals search

<http://auto.somanuals.com>

TV manuals search

<http://tv.somanuals.com>