



SureFlow™
TECHNOLOGY



HeatSeal H212/H312 with SureFlow™ Technology

- ⓖ *Instruction Manual*
- ⓕ *Manuel d'utilisation*
- ⓓ *Bedienungsanleitung*
- Ⓡ *Manuale d'istruzioni*
- ⓃⓁ *Gebruiksaanwijzing*
- ⓔ *Manual de instrucciones*
- Ⓟ *Manual de Instruções*
- ⓉⓇ *Kullanım Kılavuzu*
- ⓖⓇ *Οδηγίες*
- ⓓⓀ *Brugsvejledning*
- ⓕⓂ *Käyttöopas*
- Ⓝⓞ *Bruksanvisning*
- Ⓢ *Bruksanvisning*
- ⓅⓁ *Instrukcja obsługi*
- ⒸⓏ *Návod k obsluze*
- ⓗ *Használati útmutató*
- ⓇⓞⓈ *Руководство по эксплуатации*



ATTENTION

To register and activate
the warranty go to
www.accoeurope.com

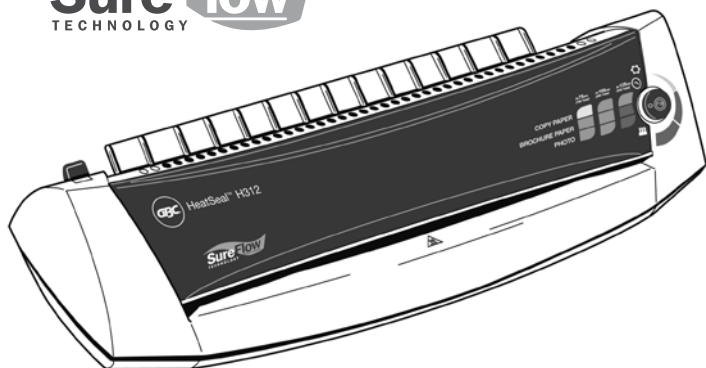
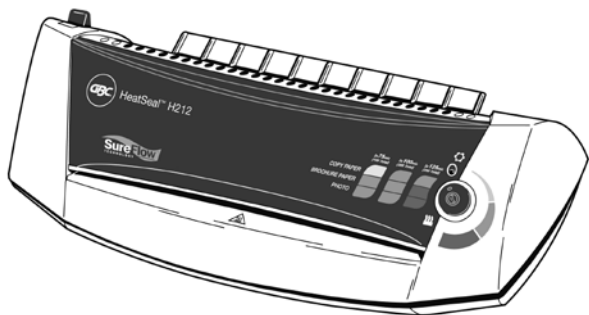

| | |
|-------------------|-----------|
| English | 4 |
| Français | 6 |
| Deutsch | 8 |
| Italiano | 10 |
| Nederlands | 12 |
| Español | 14 |
| Português | 16 |
| Türkçe | 18 |
| Ελληνικά | 20 |
| Dansk | 22 |
| Suomi | 24 |
| Norsk | 26 |
| Svenska | 28 |
| Polski | 30 |
| Česky | 32 |
| Magyar | 34 |
| Русский | 36 |

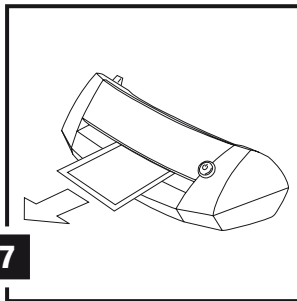
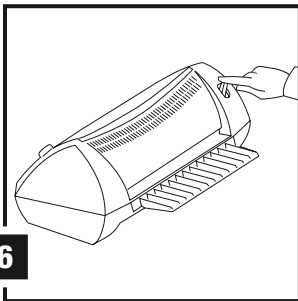
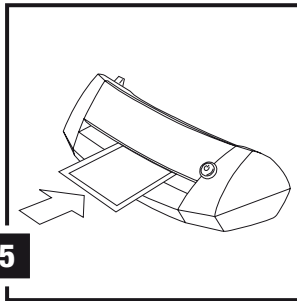
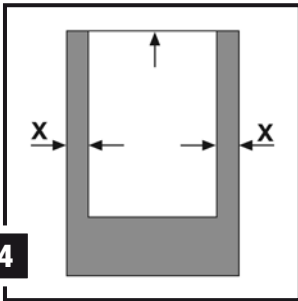
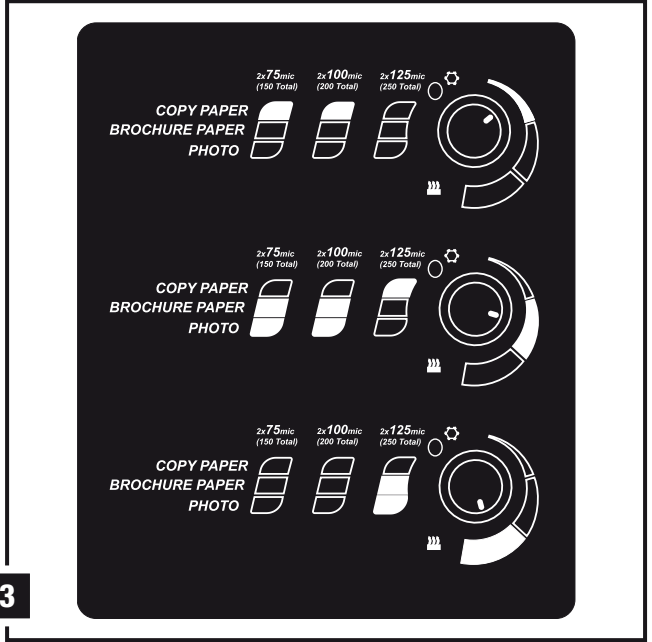
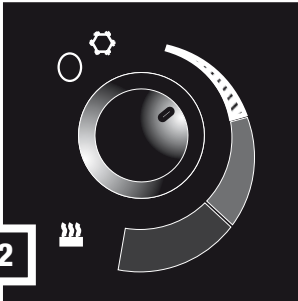
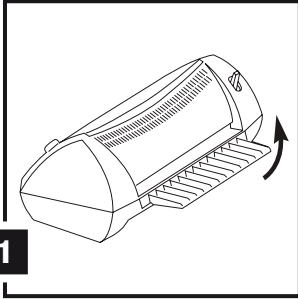



Safety instructions



YOUR SAFETY AS WELL AS THE SAFETY OF OTHERS IS IMPORTANT TO ACCO BRANDS EUROPE. IN THIS INSTRUCTION MANUAL AND ON THE PRODUCT ARE IMPORTANT SAFETY MESSAGES. READ THESE MESSAGES CAREFULLY.



THE SAFETY ALERT SYMBOL PRECEDES EACH SAFETY MESSAGE IN THIS INSTRUCTION MANUAL.

THIS SYMBOL INDICATES A POTENTIAL PERSONAL SAFETY HAZARD THAT COULD HURT YOU OR OTHERS, AS WELL AS CAUSE PRODUCT DAMAGE OR PROPERTY DAMAGE.

THIS WARNING IS FOUND ON THE PRODUCT.



This safety message means that you could be seriously hurt or killed if you open the product and expose yourself to hazardous voltage.

The following ISO and IEC symbols appear on this product, and their meanings are as follows:



On / Off



Cold



Release



Heat

Special notice

Thank you, for your recent purchase of a GBC Pouch Laminator. Your new laminator may emit a slight odour during the initial stage of operation. It is normal and will diminish after several hours of operation.

Cleaning



Caution: Unplug this product before cleaning.

- Wipe exterior only with a damp cloth. Do not use detergents or solvents.
- Do not use aerosol dusters or cleaners.
- Do not spray anything into the machine.

Important safeguards



WARNING: FOR YOUR PROTECTION DO NOT CONNECT THE POUCH LAMINATOR TO ELECTRICAL POWER UNTIL YOU READ THESE INSTRUCTIONS COMPLETELY. KEEP THESE INSTRUCTIONS IN A CONVENIENT LOCATION FOR FUTURE REFERENCE. TO GUARD AGAINST INJURY, THE FOLLOWING BASIC SAFETY PRECAUTIONS MUST BE OBSERVED IN THE SET-UP AND USE OF THIS PRODUCT.

General safeguards

- Use the unit only for its intended purposes of laminating documents.
- Do not place anything in the throat opening of the laminator other than pouches/documents.
- Place unit on a secure, stable work area to prevent the unit from falling and possibly causing personal injury and damage to the unit.
- Follow all warnings and instructions marked on the unit.
- The socket outlet shall be installed near the equipment and shall be easily accessible.
- Do not attempt single side lamination, this will destroy the laminator.
- Do not block the vent slots, this will cause the laminator to overheat.

Electrical safeguards

- The unit must be connected to a supply voltage corresponding to the electrical rating shown on the unit.
- Unplug the unit before moving it, or when it is not in use for an extended period of time.
- Do not operate with a damaged supply cord or plug. Do not alter the attachment plug. The plug is configured for the appropriate electrical supply.
- Do not overload electrical outlets beyond their capacity; fire or electrical shock could result.
- The unit is intended for indoor use only.
- Never push objects through the cabinet slots. Do not spill liquid of any kind on this product.
- Close supervision is required when this product is used near children.

Service

- Do not attempt to service or repair the pouch laminator yourself. Unplug the unit and contact an authorised ACCO Brands Europe service representative for any required repairs.

Specifications

| | GBC HeatSeal H212 | GBC HeatSeal H312 |
|-----------------------------------|----------------------------|----------------------------|
| Electrical | 230V / 50Hz / 2Amps / 500W | 230V / 50Hz / 2Amps / 500W |
| Machine Dimensions | 400 x 173 x 117.5mm | 476x173x117mm |
| Machine Weight | 3.1kg | 3.9kg |
| Maximum Pouch Width | 241mm | 318mm |
| Maximum Pouch Thickness | 2 x 125 mic (Total 250) | 2 x 125 mic (Total 250) |
| Maximum Thru-put Thickness | 0.8mm | 0.8mm |
| Warm-Up Time (2 x 75 mic) | 5 minutes | 5 minutes |

Important: Before operating your new laminator, **lift up the exit tray** located at the rear of the machine and lock it in place (fig. 1).

Operation, hot lamination

- 1 Connect power cord to appropriate power source.
- 2 **Push the power button** to turn the power "ON" (fig. 2). The indicator will glow red.
- 3 Using the lamination guidelines (fig. 3), select the appropriate temperature setting for the pouch gauge thickness and material you are laminating.
 - If the laminated item appears to be cloudy, it means that the laminator temperature is not hot enough. Allow the laminator to heat for a few more minutes then run the pouch through again.
 - If the laminated item is wavy, the TEMPERATURE is too hot. Verify temperature selector is set at the appropriate temperature.
 - Always allow sufficient time for the laminator to adjust to changes in temperature setting.
- 4 A series of four beeps will be heard when laminator reaches operating temperature.
- 5 Position the document to be laminated into a GBC laminating pouch, so that the document is aligned to the folded sealed edge and the right and left borders are equal (fig. 4).
- 6 Insert the pouch and its contents straight into the machine, **leading with the folded edge**.
- 7 The laminated item will automatically exit the rear of the machine. After the pouch has stopped moving, immediately place it on a flat surface to cool for one minute before handling (fig. 5).
- 8 If you have finished laminating, push the switch to turn "OFF" the machine.

DO NOT LAMINATE AN EMPTY POUCH

Operation, cold lamination

- 1 Connect power cord to appropriate power source.
- 2 Rotate the temperature dial to the "cold" position (fig. 2). 
- 3 **Push the power button** to turn the power "ON" (fig. 2), the indicator light will glow red.
- 4 A series of four beeps will be heard when the laminator is ready to use.
- 5 Use and laminate your GBC cold pouch. (Pressure sensitive—non-thermal laminating pouch)

Release lever

How to use the release lever.

- 1 If pouch jams or is fed improperly, turn off the laminator immediately.
- 2 Press the release lever down to release the motor from the rollers (fig. 6).
- 3 Pull your document back out of the laminator while pressing the release lever down (fig. 7).
- 4 Clean the rollers by running the cleaning sheet supplied with the laminator through the machine 2 or 3 times in the hot operation mode (red zone on temperature dial). If you do not have this sheet, use a similar cardboard sheet that fits the width of the laminator.
- 5 Continue laminating.

Helpful lamination hints

- 1 **Temperature setting Guidelines:**
When laminating thin paper with light ink coverage, set the temperature dial at the low end of the range. Thick paper and heavy ink coverage require higher settings. Temperature settings will vary due to the finish, chemistry and heat absorption properties of the material being laminated.
- 2 Before laminating important or unique documents always run a test pouch through the laminator using a similar type document.
- 3 Do not attempt to do single sided lamination. This will destroy the laminator.
- 4 As soon as the lamination is completed, remove from the rear of the machine and place on a cool flat surface for cooling to prevent the pouch from curling.
- 5 Do not block the vent slots, this will cause the laminator to overheat.

Guarantee

Operation of this machine is guaranteed for two years from date of purchase, subject to normal use. Within the guarantee period, ACCO Brands Europe will at its own discretion either repair or replace the defective machine free of charge. Defects due to misuse or use for inappropriate purposes are not covered under the guarantee. Proof of date of purchase will be required. Repairs or alterations made by

persons not authorised by ACCO Brands Europe will invalidate the guarantee. It is our aim to ensure that our products perform to the specifications stated. This guarantee does not affect the legal rights which consumers have under applicable national legislation governing the sale of goods.

Register this product online at www.accoeuropa.com

Service

GB ACCO Service Division

Freeport 193, Hereward Rise, Halesowen, West Midlands, B62 8AN.
Tel: 0845 658 6600, Fax: 0870 4215576, www.acco.co.uk/service

ACCO UK Sales International

Oxford Road, Aylesbury, HP21 8SZ.
Tel: 00 44 1296 397444, Fax: 00 44 1296 311000

F ACCO France

Service Après-Vente, 8 Rue du 19 Mars 1962, 21601 Longvic, Cedex BP7/ZI.
Tel: 0802 872 356, Fax: 03 80 68 60 49

NL ACCO Benelux

Peppelkade 64, 3992AK Houten.
Tel: 030-6346060, Fax: 030-6346070, info@accobenelux.nl, www.accobenelux.nl

B ACCO Benelux (Technische Dienst)

Peppelkade 64, 3992AK Houten, Nederland.
Tel: 02-4117416, Fax: 02-4140784, info@accobenelux.be, www.accobenelux.be

D ACCO Deutschland

Arnold Arnoldstrasse 5, 73614 Scorndorf, Germany.
H Tel: +49 - 7181/887-160, Fax: +49 - 7181/887-165

CZ XERTEC a.s.

U Továren 770/1b, 102 00, Praha 10.
Tel: +420 271 741 800, Fax: +420 271 743 143, www.xertec.cz

A ACCO Österreich

Sallmann Bürotechnik GmbH, Eshaverstrasse 16, 5020 Salzburg.
Tel: 0662 4345 160, Fax: 0662 4345 164, e-mail: schinagl@sallmann.at

S ACCO Schweiz

ABC Bürotechnik AG, Winkelbüel 4, 6043 Adligenswil.
Tel: 041 375 6060, Fax: 041 375 6061,
e-mail: bruno.zraggen@abc-buerotechnik.ch

DK Mailtech

Baldersbaekvej 8B 2635 Ishøj.
Tel: 045 43 73 37 37, Fax: 0045 43 73 73 37 07, e-mail: hs@mailtech.dk

N Sannum & Stang

Gladengveien 16 0661 Oslo.
Tel: +4722685940, Fax: +4722686730, e-mail: post@sansta.no

I ACCO Italia Spa

Via Nenni 13, Settimo Torinese (TO) Via Regio Parco 10B/bis.
Tel: 011 896 11 11, Fax: 011 896 11 12

IRE ACCO-Rexel Ltd

Clonshaugh Business & Technology Park, Clonshaugh Dublin 17.
Tel: 01 816 4300, Fax: 01 816 4302

PL ACCO Polska Sp. z o.o.

Al-Jerozolimskie 184, 02-486 Warszawa.
Tel: +42 22 570 18 01, Fax: +48 22 570 18 33

S ACCO Nordic Region

Kontor 1, i norden AB Kanalvägen 16 194 61 Upplands Väsby.
Tel: 08 444 5191, Fax: 08 444 5199

FI Somen Huoltopalvelu oy

Kanaamouka 1 00360 Helsinki. Tel: 956 050 510, Fax: 956 050 500

E ACCO Iberia SL

P Isaac Peral 19, 28820 Coslada (Madrid). Tel: 91 669 9391, Fax: 91 672 07 11

IS Oddi

Höfðabakka 3-7 IS-112 Reykjavik. Tel: 00354 515 5000, Fax: 00354 515 5101

TR Eraysan

Ankara Cad N.129, Sirkeci, Istanbul.
Tel: 0090 212 6591686, Fax: 0090 212 5226992, eraysan@eraysan.com.tr

AUS ACCO Australia Pty.

Level 2 Building B, 8 Lord Street, Botany, NSW, Australia 2019.
Tel: 2 9700 0180, Fax: 2 9700 0195



Free Manuals Download Website

<http://myh66.com>

<http://usermanuals.us>

<http://www.somanuals.com>

<http://www.4manuals.cc>

<http://www.manual-lib.com>

<http://www.404manual.com>

<http://www.luxmanual.com>

<http://aubethermostatmanual.com>

Golf course search by state

<http://golfingnear.com>

Email search by domain

<http://emailbydomain.com>

Auto manuals search

<http://auto.somanuals.com>

TV manuals search

<http://tv.somanuals.com>