

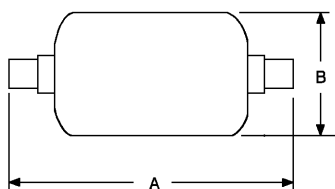

96-TBF

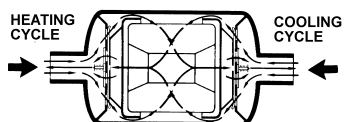

**96-TBF Series
Dimensional Drawing**

96-TBF BI-DIRECTIONAL HEAT PUMP DRIERS

Bi-Directional Driers Designed to Provide Complete Protection to Your Heat Pump or Reverse Cycle System. This Compact Design Filters Contaminants, Removes Moisture & Acids During the Cooling & Heating Cycles During Winter and Summer. Internal Check Valves Prevent the Release of Collected Contaminants When the Heat Pump Cycles from the Heating to Cooling Modes

FEATURES

- Proven, nylon internal check valves.
- Solid block desiccant core: a composite of molecular sieve and activated alumina.
- Provides high moisture, organic and inorganic acid removal.
- The addition of charcoal to the desiccant core allows for the removal of wax that may occur at low evaporator temperatures.
- Nickel plated SAE flare and solid copper ODF fittings.
- Corrosion resistant paint.

SPECIFICATIONS

Maximum Working Pressure 500 psig
 Minimum Burst Pressure 2500 psig
 Agency U.L. file number SA7175
 C.S.A. file number LR100624

INSTALLATION NOTE: The drier may be installed in any position in the reversing liquid line.

SELECTION NOTE: Given the proper liquid line size, connection type and tonnage of the refrigerant system, the correct drier may be selected using the chart below. Choosing a unit size with sufficient water capacity to reduce moisture content of the system to a safe level should be considered.

SELECTION: CONNECTIONS, DIMENSIONS, FLOW CAPACITIES

Model Number	Connections size & type	Dimension		① Flow Capacity
		A	B	Tons @ 2 psi ▲P
96-TBF083	3/8 SAE	6.28	2.63	6.6
96-TBF083S	3/8 ODF	5.63	2.63	7.4
96-TBF163	3/8 SAE	6.97	2.63	6.7
96-TBF163S	3/8 ODF	6.31	2.63	7.5
96-TBF164	1/2 SAE	7.22	2.63	11.2
96-TBF164S	1/2 ODF	6.34	2.63	11.7
96-TBF165S	5/8 ODF	6.63	3.09	12.4

① All ratings in accordance with ARI standard 710-86: 2.9 lbs./min./ton for R-22

REFRIGERATION

Free Manuals Download Website

<http://myh66.com>

<http://usermanuals.us>

<http://www.somanuals.com>

<http://www.4manuals.cc>

<http://www.manual-lib.com>

<http://www.404manual.com>

<http://www.luxmanual.com>

<http://aubethermostatmanual.com>

Golf course search by state

<http://golfingnear.com>

Email search by domain

<http://emailbydomain.com>

Auto manuals search

<http://auto.somanuals.com>

TV manuals search

<http://tv.somanuals.com>