



# PX-S5000

## Quick Start Guide

After reading this document, keep it in a safe place along with the warranty certificate. Be sure to read the "Safety Precautions" in the separate "READ THIS!" sheet, and use the product correctly.

For more detailed information about the product and its operation, visit the CASIO website. Available Information: User's Guide, etc.

<https://support.casio.com/global/en/emi/manual/PX-S5000/>



When the Digital Piano is being operated on battery power only, notes may sound distorted when performing or playing back a song at maximum volume. This is due to the difference between AC adaptor power and battery power, and does not indicate Digital Piano malfunction. If you notice distortion, switch to AC adaptor power or lower the volume level.

### Included Accessories

- Music Stand
  - AC adaptor
  - Power cord
  - Pedal
  - Wireless MIDI & audio adaptor
  - Leaflets
    - READ THIS! Sheet
    - Other (Warranty, etc.)
- Items included as accessories are subject to change without notice.

## Preparation

### Preparing a Power Supply

#### Using the AC Adaptor

- Connect the AC adaptor as shown in the illustration on the right.
  - Make sure that you use only the AC adaptor specified for this Digital Piano.

#### Using Batteries

- Bottom of console
- Load six AA-size batteries.
- Close
- Specify the battery type. Specify the battery type by holding down the **FUNCTION** button and pressing the F7 key. One tone: Alkaline batteries Two tones: Rechargeable nickel metal hydride batteries\*

\* The volume and sound quality are adjusted to suit the battery characteristics.

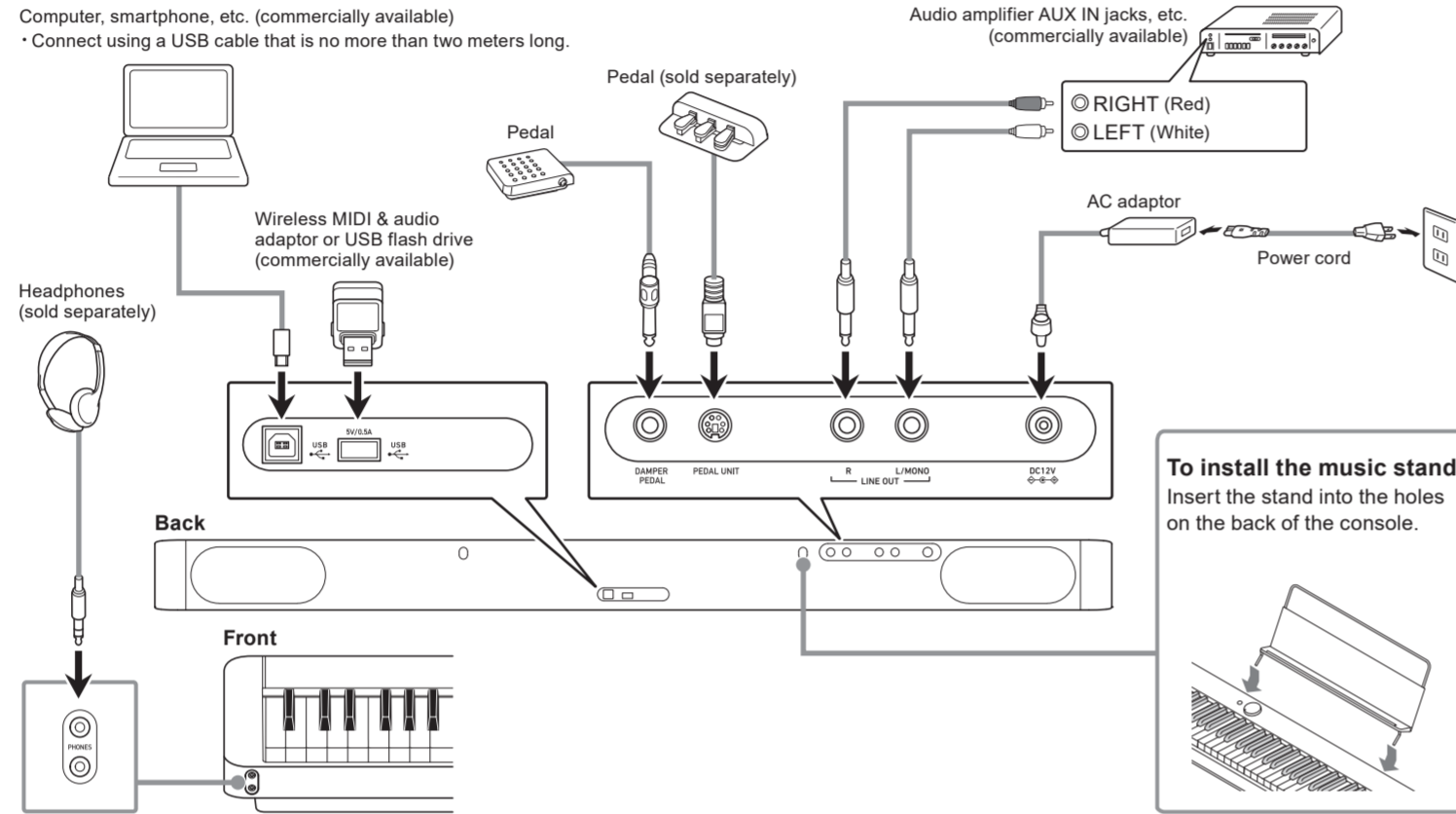

## Basic Operation

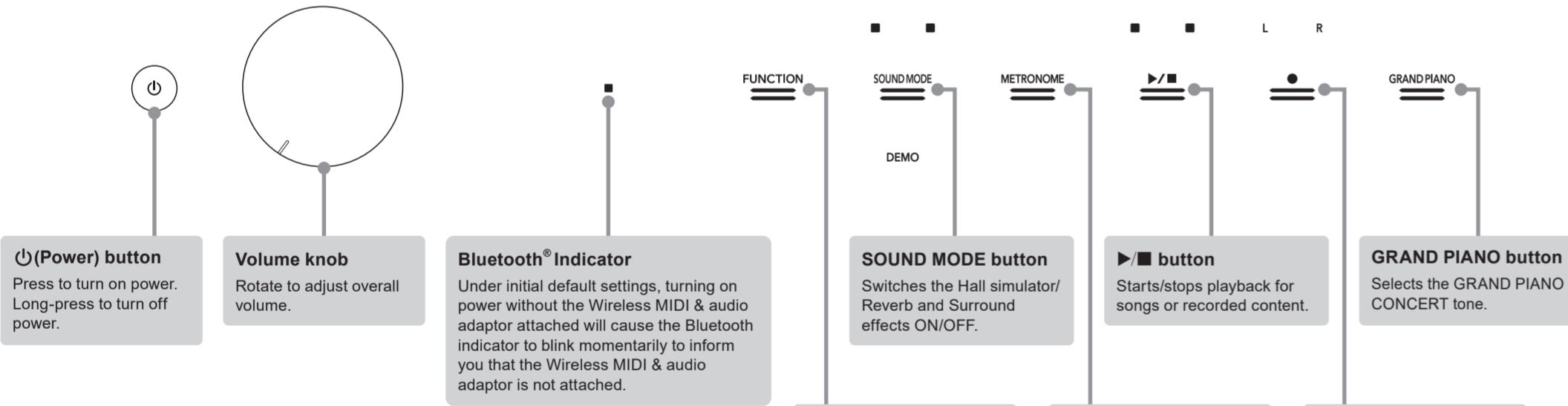

### Wireless functions (using the Included Wireless MIDI & audio adaptor)

- The operations described below are enabled while the Wireless MIDI & audio adaptor is plugged into the USB Type A port.
- Sound playback of a Bluetooth-connected smart device through the Digital Piano's speakers
  - Use MIDI functions over a Bluetooth Low Energy connection
  - Use a smart device app

### Touch Response

Pressing a key harder produces louder sound, while a softer key press produces softer sound.

### Auto Power Off

If the Digital Piano is left unused, it automatically shuts down after approximately 4 hours when using the AC adaptor or after 6 minutes when using batteries (On, Off switchable).

### Pedal

Functions as a damper pedal under the Digital Piano's initial default settings. To use the optional pedal unit (SP-34), connect it to the PEDAL UNIT jack.

### Demo Play

Hold down the **FUNCTION** button and touch the **SOUND MODE** button to start demo song playback. Touch the **▶/■** button to stop playback.

### Performance Recording/Playback

Touch the **(REC)** button and begin playing on the keyboard. To end the recording, touch the **(REC)** button again. To play back the recorded content, touch the **▶/■** button.

● For detailed information on using the functions, refer to the User's Guide on the CASIO website.

## Basic Settings Such as Tuning

### FUNCTION

- Select a key while holding down the **FUNCTION** button.
- If you press a key while changing a setting, the number of times the notification tone sounds varies according to the value set and the sequence.
  - When you disable a setting, a low tone sounds.

A0	Auto Power Off disable/enable	B0	Panel Lock disable/enable/Auto	C1	Wireless MIDI & audio adaptor	B1	Notification Tone set selection	D2	Wireless MIDI & audio adaptor	B2	Notification Tone Volume (-)	E3	Wireless MIDI & audio adaptor	B3	Notification Tone Volume (+)	F4	Wireless MIDI & audio adaptor	B4	Panel Light setting	G5	Wireless MIDI & audio adaptor	B5	Battery Type Alkaline/Ni-MH	A6	Wireless MIDI & audio adaptor	B6	Speaker Out disable/enable/Auto	B7	Wireless MIDI & audio adaptor	B7	Touch Button Sensitivity (-)	B8	Wireless MIDI & audio adaptor	B8	Touch Button Sensitivity (+)	B9	Wireless MIDI & audio adaptor	B9	Touch Button Luminosity	C0	Wireless MIDI & audio adaptor	B0	Panel Function	C1	Wireless MIDI & audio adaptor	B1	Keyboard Channel (+)	C2	Wireless MIDI & audio adaptor	B2	Keyboard Channel (-)	C3	Wireless MIDI & audio adaptor	B3	Local Control off/on	C4	Wireless MIDI & audio adaptor	B4	Local Control off/on	C5	Wireless MIDI & audio adaptor	B5	Local Control off/on	C6	Wireless MIDI & audio adaptor	B6	Local Control off/on	C7	Wireless MIDI & audio adaptor	B7	Local Control off/on	C8	Wireless MIDI & audio adaptor	B8	Local Control off/on	C9	Wireless MIDI & audio adaptor	B9	Local Control off/on	D0	Wireless MIDI & audio adaptor	B0	Local Control off/on	D1	Wireless MIDI & audio adaptor	B1	Local Control off/on	D2	Wireless MIDI & audio adaptor	B2	Local Control off/on	D3	Wireless MIDI & audio adaptor	B3	Local Control off/on	D4	Wireless MIDI & audio adaptor	B4	Local Control off/on	D5	Wireless MIDI & audio adaptor	B5	Local Control off/on	D6	Wireless MIDI & audio adaptor	B6	Local Control off/on	D7	Wireless MIDI & audio adaptor	B7	Local Control off/on	D8	Wireless MIDI & audio adaptor	B8	Local Control off/on	D9	Wireless MIDI & audio adaptor	B9	Local Control off/on	E0	Wireless MIDI & audio adaptor	B0	Local Control off/on	E1	Wireless MIDI & audio adaptor	B1	Local Control off/on	E2	Wireless MIDI & audio adaptor	B2	Local Control off/on	E3	Wireless MIDI & audio adaptor	B3	Local Control off/on	E4	Wireless MIDI & audio adaptor	B4	Local Control off/on	E5	Wireless MIDI & audio adaptor	B5	Local Control off/on	E6	Wireless MIDI & audio adaptor	B6	Local Control off/on	E7	Wireless MIDI & audio adaptor	B7	Local Control off/on	E8	Wireless MIDI & audio adaptor	B8	Local Control off/on	E9	Wireless MIDI & audio adaptor	B9	Local Control off/on	F0	Wireless MIDI & audio adaptor	B0	Local Control off/on	F1	Wireless MIDI & audio adaptor	B1	Local Control off/on	F2	Wireless MIDI & audio adaptor	B2	Local Control off/on	F3	Wireless MIDI & audio adaptor	B3	Local Control off/on	F4	Wireless MIDI & audio adaptor	B4	Local Control off/on	F5	Wireless MIDI & audio adaptor	B5	Local Control off/on	F6	Wireless MIDI & audio adaptor	B6	Local Control off/on	F7	Wireless MIDI & audio adaptor	B7	Local Control off/on	F8	Wireless MIDI & audio adaptor	B8	Local Control off/on	F9	Wireless MIDI & audio adaptor	B9	Local Control off/on	G0	Wireless MIDI & audio adaptor	B0	Local Control off/on	G1	Wireless MIDI & audio adaptor	B1	Local Control off/on	G2	Wireless MIDI & audio adaptor	B2	Local Control off/on	G3	Wireless MIDI & audio adaptor	B3	Local Control off/on	G4	Wireless MIDI & audio adaptor	B4	Local Control off/on	G5	Wireless MIDI & audio adaptor	B5	Local Control off/on	G6	Wireless MIDI & audio adaptor	B6	Local Control off/on	G7	Wireless MIDI & audio adaptor	B7	Local Control off/on	G8	Wireless MIDI & audio adaptor	B8	Local Control off/on	G9	Wireless MIDI & audio adaptor	B9	Local Control off/on	A0	Wireless MIDI & audio adaptor	B0	Local Control off/on	A1	Wireless MIDI & audio adaptor	B1	Local Control off/on	A2	Wireless MIDI & audio adaptor	B2	Local Control off/on	A3	Wireless MIDI & audio adaptor	B3	Local Control off/on	A4	Wireless MIDI & audio adaptor	B4	Local Control off/on	A5	Wireless MIDI & audio adaptor	B5	Local Control off/on	A6	Wireless MIDI & audio adaptor	B6	Local Control off/on	A7	Wireless MIDI & audio adaptor	B7	Local Control off/on	A8	Wireless MIDI & audio adaptor	B8	Local Control off/on	A9	Wireless MIDI & audio adaptor	B9	Local Control off/on	B0	Wireless MIDI & audio adaptor	B0	Local Control off/on	B1	Wireless MIDI & audio adaptor	B1	Local Control off/on	B2	Wireless MIDI & audio adaptor	B2	Local Control off/on	B3	Wireless MIDI & audio adaptor	B3	Local Control off/on	B4	Wireless MIDI & audio adaptor	B4	Local Control off/on	B5	Wireless MIDI & audio adaptor	B5	Local Control off/on	B6	Wireless MIDI & audio adaptor	B6	Local Control off/on	B7	Wireless MIDI & audio adaptor	B7	Local Control off/on	B8	Wireless MIDI & audio adaptor	B8	Local Control off/on	B9	Wireless MIDI & audio adaptor	B9	Local Control off/on
----	-------------------------------	----	--------------------------------	----	-------------------------------	----	---------------------------------	----	-------------------------------	----	------------------------------	----	-------------------------------	----	------------------------------	----	-------------------------------	----	---------------------	----	-------------------------------	----	-----------------------------	----	-------------------------------	----	---------------------------------	----	-------------------------------	----	------------------------------	----	-------------------------------	----	------------------------------	----	-------------------------------	----	-------------------------	----	-------------------------------	----	----------------	----	-------------------------------	----	----------------------	----	-------------------------------	----	----------------------	----	-------------------------------	----	----------------------	----	-------------------------------	----	----------------------	----	-------------------------------	----	----------------------	----	-------------------------------	----	----------------------	----	-------------------------------	----	----------------------	----	-------------------------------	----	----------------------	----	-------------------------------	----	----------------------	----	-------------------------------	----	----------------------	----	-------------------------------	----	----------------------	----	-------------------------------	----	----------------------	----	-------------------------------	----	----------------------	----	-------------------------------	----	----------------------	----	-------------------------------	----	----------------------	----	-------------------------------	----	----------------------	----	-------------------------------	----	----------------------	----	-------------------------------	----	----------------------	----	-------------------------------	----	----------------------	----	-------------------------------	----	----------------------	----	-------------------------------	----	----------------------	----	-------------------------------	----	----------------------	----	-------------------------------	----	----------------------	----	-------------------------------	----	----------------------	----	-------------------------------	----	----------------------	----	-------------------------------	----	----------------------	----	-------------------------------	----	----------------------	----	-------------------------------	----	----------------------	----	-------------------------------	----	----------------------	----	-------------------------------	----	----------------------	----	-------------------------------	----	----------------------	----	-------------------------------	----	----------------------	----	-------------------------------	----	----------------------	----	-------------------------------	----	----------------------	----	-------------------------------	----	----------------------	----	-------------------------------	----	----------------------	----	-------------------------------	----	----------------------	----	-------------------------------	----	----------------------	----	-------------------------------	----	----------------------	----	-------------------------------	----	----------------------	----	-------------------------------	----	----------------------	----	-------------------------------	----	----------------------	----	-------------------------------	----	----------------------	----	-------------------------------	----	----------------------	----	-------------------------------	----	----------------------	----	-------------------------------	----	----------------------	----	-------------------------------	----	----------------------	----	-------------------------------	----	----------------------	----	-------------------------------	----	----------------------	----	-------------------------------	----	----------------------	----	-------------------------------	----	----------------------	----	-------------------------------	----	----------------------	----	-------------------------------	----	----------------------	----	-------------------------------	----	----------------------	----	-------------------------------	----	----------------------	----	-------------------------------	----	----------------------	----	-------------------------------	----	----------------------	----	-------------------------------	----	----------------------	----	-------------------------------	----	----------------------	----	-------------------------------	----	----------------------	----	-------------------------------	----	----------------------	----	-------------------------------	----	----------------------	----	-------------------------------	----	----------------------	----	-------------------------------	----	----------------------	----	-------------------------------	----	----------------------	----	-------------------------------	----	----------------------	----	-------------------------------	----	----------------------	----	-------------------------------	----	----------------------	----	-------------------------------	----	----------------------

If you select a function marked with an asterisk (\*), pressing the C1 key executes that function.

**Example:** To restore the factory default settings (factory reset)  
Hold down the **FUNCTION** button and press the A0 key and then the C1 key.

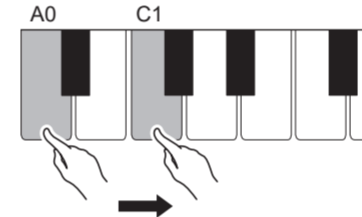

## Reference

### Product Specifications

- Model:** PX-S5000BK  
**Keyboard:** 88-key piano keyboard; Duet: Adjustable tone range (-2 to +2 octaves); Transpose: -12 to 0 to +12 semitones; Octave shift: -2 to 0 to +2 octaves  
**Sound Source:** Number of Tones: 23 (22 full-keyboard tones + 1 low-range bass tone); Layer (excluding bass tone); Split (bass tone only in low range); Maximum polyphony: 192 notes; Touch Response (5 sensitivity levels, Off); Tuning: 415.5Hz to 440.0Hz to 465.9Hz (0.1Hz units); Temperament: Equal temperaments plus 16 other types  
**Acoustic Simulator:** Hammer response, Key off response, String resonance, Damper resonance, Damper noise, Key on action noise, Key off action noise  
**Sound Mode:** Hall simulator (4 types), Reverb (8 types), Surround (2 types)  
**Other Effects:** Chorus (4 types), Brilliance (-3 to 0 to 3), Headphones mode  
**Demo Song:** 1  
**Music Library:** Built-in Songs: 60, User Songs: 10 (Up to approximately 100KB per song, approximately 1MB for 10 songs)\*; Song volume: Adjustable (Setting also affects MIDI recorder song playback); Part On/Off: L, R  
 \* Based on 1KB = 1024bytes, 1MB = 1024<sup>2</sup> bytes  
**MIDI Recorder:** Functions: Real-time recording, playback; Number of Song: 1; Number of Tracks: 2; Capacity: Approximately 10,000 notes total; Recorded Data Protection: Built-in flash memory; MIDI recorder volume: Adjustable (Setting also affects Music Library song playback.)  
**Audio Recorder:** Real-time recording and playback as audio data; Number of songs: 99 (files); File format: WAV (linear PCM, 16bit, 44.1kHz, stereo); Maximum recording time: Approximately 25 minutes per file; Recording medium: USB Flash Drive  
**Metronome:** Beat bell: Off, 1 to 9 (beats); Tempo Range: 20 to 255; Metronome Volume Level: Adjustable  
**Pedals:** Included SP-3 pedal assignable functions: Damper (off, on), sostenuto (off, on), soft (off, on), metronome (start, stop), tempo setting; Separately available SP-34 pedal unit: Damper (continuously variable), sostenuto (off, on), soft (off, on)  
**Other Functions:** Auto Resume; Operation Lock; Notification tones (Selectable sets 1, 2, 3; Adjustable volume)  
**MIDI:** 16-channel multi-timbre receive  
**Inputs/Outputs:** PHONES jacks: Stereo mini jacks (3.5mm) × 2; Power: 12V DC; LINE OUT R, L/MONO jacks: Standard jacks (6.3mm) × 2 (Output impedance: 600Ω, Output voltage: 1.3V (RMS) MAX); USB port: Type A, Type B; DAMPER PEDAL jack: Standard jack (6.3mm); PEDAL UNIT jack: Proprietary jack  
**Acoustics:** Amp output: 8W + 8W; Speakers: 16cm × 8cm (oval) × 2  
**Power Supply:** 2-way power supply  
 Auto Power Off: Approximately 4 hours (under AC adaptor power) or 6 minutes (under battery power) after last operation, can be disabled.  
 AC Adaptor: AD-A12150LW  
 Batteries: 6 AA-size alkaline batteries or AA-size rechargeable nickel metal hydride batteries; Approximately 4 hours (alkaline batteries) or approximately 4 hours (nickel metal hydride batteries) continuous operation\*  
 \* Measured values while using enloop batteries.  
 enloop is a trademark of Panasonic Corporation.  
 ● Actual continuous operation time may be shorter due to battery type, performance type, and usage environment.  
 ● Specifying the wrong battery type can cause incorrect display of the battery level and sudden loss of power.  
**Power consumption:** 12V --- 10W  
**Dimensions:** 132.2 (W) × 23.2 (D) × 10.2 (H) cm (52 1/16 × 9 1/8 × 4 inch)  
**Weight:** Approximately 11.5 kg (25.4 lbs) (without batteries)  
 ● Specifications and designs are subject to change without notice.

- Any reproduction of the contents of this manual, either in part or its entirety, is prohibited. Except for your own, personal use, any other use of the contents of this manual without the consent of CASIO is prohibited under copyright laws.
- IN NO EVENT SHALL CASIO BE LIABLE FOR ANY DAMAGES WHATSOEVER (INCLUDING, WITHOUT LIMITATION, DAMAGES FOR LOSS OF PROFITS, BUSINESS INTERRUPTION, LOSS OF INFORMATION) ARISING OUT OF THE USE OF OR INABILITY TO USE THIS MANUAL OR PRODUCT, EVEN IF CASIO HAS BEEN ADVISED OF THE POSSIBILITY OF SUCH DAMAGES.
- The contents of this manual are subject to change without notice.
- Company and product names used in this manual may be registered trademarks of others.

### Declaration of Conformity

Model Number: PX-S5000  
 Trade Name: CASIO COMPUTER CO., LTD.  
 Responsible party: CASIO AMERICA, INC.  
 Address: 570 MT. PLEASANT AVENUE, DOVER, NEW JERSEY 07801  
 Telephone number: 973-361-5400  
 This device complies with Part 15 of the FCC Rules. Operation is subject to the following two conditions:  
 (1) This device may not cause harmful interference, and (2) this device must accept any interference received, including interference that may cause undesired operation.

A labels rating is affixed to the bottom of the product.

### Functions Not Covered in This Manual

These instructions provide general information about main functions. For more detailed information, refer to the "User's Guide".

<https://support.casio.com/global/en/emi/manual/PX-S5000/>

### The "User's Guide" includes information on the topics listed below.

- 23 tones for keyboard play
- Adjustable Touch Response
- Hall simulator/Reverb and surround effects
- Metronome to guide practice
- Duet Mode
- Built-in tune playback and practice
- Keyboard play recording
- Smart device linking for enhanced function
- Other

### About Music Score data

You can download music score data as a PDF file from the CASIO website. You will then be able to view music scores on your smart device. You can jump from the PDF file table of contents directly to the music score you want, and you can print out scores as needed.

<https://support.casio.com/global/en/emi/manual/PX-S5000/>



## Changing Settings Such as the Sound Mode

### SOUND MODE

Select a key while holding down the **SOUND MODE** button.

- If you press a key while changing a setting, the number of times the notification tone sounds varies according to the value set and the sequence.
- When you disable a setting, a low tone sounds.

A0	Opera Hall
B0	Room 3
C1	Room 1
D1	Room 2
E1	Room 3
F1	Hall 1
G1	Hall 2
A1	Stadium
B1	Hall Simulator/Reverb depth (+)
C2	Hall Simulator/Reverb depth (-)
D2	Wireless Hall Simulator/Reverb depth (+)
E2	Wireless Hall Simulator/Reverb depth (-)
F2	Chorus (1)
G2	Chorus (2)
A2	Chorus (3)
B2	Chorus (4)
C3	Brilliance (+)
D3	Brilliance (-)
E3	String Resonance (1)
F3	String Resonance (2)
G3	String Resonance (3)
A3	String Resonance (4)
B3	Damper Resonance (1)
C4	Damper Resonance (2)
D4	Damper Resonance (3)
E4	Damper Resonance (4)
F4	Damper Noise (1)
G4	Damper Noise (2)
A4	Damper Noise (3)
B4	Damper Noise (4)
C5	Key On Action Noise (1)
D5	Key On Action Noise (2)
E5	Key On Action Noise (3)
F5	Key On Action Noise (4)
G5	Key Off Action Noise (1)
A5	Key Off Action Noise (2)
B5	Key Off Action Noise (3)
C6	Key Off Action Noise (4)
D6	Key On Action Noise (1)
E6	Key On Action Noise (2)
F6	Key On Action Noise (3)
G6	Key On Action Noise (4)
A6	Key On Action Noise (1)
B6	Key On Action Noise (2)
C7	Key On Action Noise (3)
D7	Key On Action Noise (4)
E7	Key On Action Noise (1)
F7	Key On Action Noise (2)
G7	Key On Action Noise (3)
A7	Key On Action Noise (4)
B7	Key On Action Noise (1)
C8	Key On Action Noise (2)

Brilliance (A greater setting value increases the level of the effect applied.)

Acoustic Simulator (A greater setting value increases the level of the effect applied.)

Sound Mode Effects

Chorus

## Using the Sound Mode Effects (Hall Simulator/Reverb and Surround)

To enable or disable the Hall Simulator/Reverb and Surround effects

The LED lights change as shown below each time you touch the **SOUND MODE** button.

	<input type="checkbox"/>	<input type="checkbox"/>	<input type="checkbox"/>
	SOUND MODE	SOUND MODE	SOUND MODE
Hall simulator/Reverb	ON	ON	OFF
Surround	OFF	ON	OFF

To specify the Hall Simulator/Reverb type

Hall Simulator

The hall simulator effect simulates the rich clarity, unconstrained brilliance, and other distinctive acoustic characteristics of world-famous concert halls and structures.

Hold down the **SOUND MODE** button and press any key from A0 to C1.

Reverb

Reverb simulates ambient spaces, such as a room or hall.

Hold down the **SOUND MODE** button and press any key from C#1 to A#1.

## Changing the Metronome and Tempo Settings

### METRONOME

Select a key while holding down the **METRONOME** button.

- If you press a key while changing a setting, the number of times the notification tone sounds varies according to the value set and the sequence.
- When you disable a setting, a low tone sounds.

A0	Metronome Volume (-)
B0	Metronome Volume (+)
C1	Off
D1	Off
E1	Off
F1	Off
G1	Off
A1	Off
B1	Off
C2	Off
D2	Off
E2	Off
F2	Off
G2	Off
A2	Off
B2	Off
C3	Off
D3	Off
E3	Off
F3	Off
G3	Off
A3	Off
B3	Off
C4	Off
D4	Off
E4	Off
F4	Off
G4	Off
A4	Off
B4	Off
C5	Off
D5	Off
E5	Off
F5	Off
G5	Off
A5	Off
B5	Off
C6	Off
D6	Off
E6	Off
F6	Off
G6	Off
A6	Off
B6	Off
C7	Off
D7	Off
E7	Off
F7	Off
G7	Off
A7	Off
B7	Off
C8	Off

Tempo setting (10-key)

Tempo setting (tempo markings)

Metronome Beat

## Using the Metronome

Touch the **METRONOME** button to start the metronome.

Touch the **METRONOME** button again to stop the metronome.

## Setting the Tempo Using the Number Keys (10-key)

Hold down the **METRONOME** button and use the B0 to A#1 keys to enter the tempo setting.

Input three digits for the tempo setting value.

## Selecting Songs

### GRAND PIANO

Select a key while holding down the **GRAND PIANO** button.

- If you press a key while changing a setting, the number of times the notification tone sounds varies according to the value set and the sequence.
- When you disable a setting, a low tone sounds.

A0	USB drive MIDI Song
B0	MIDI Recorder Song
C1	1
D1	2
E1	3
F1	4
G1	5
A1	6
B1	7
C2	8
D2	9
E2	0
F2	1
G2	2
A2	3
B2	4
C3	5
D3	6
E3	7
F3	8
G3	9
A3	0
B3	1
C4	2
D4	3
E4	4
F4	5
G4	6
A4	7
B4	8
C5	9
D5	0
E5	1
F5	2
G5	3
A5	4
B5	5
C6	6
D6	7
E6	8
F6	9
G6	0
A6	1
B6	2
C7	3
D7	4
E7	5
F7	6
G7	7
A7	8
B7	9
C8	0

Song selection (10-key)

Music Library (song number)

## Inputting Song Numbers Using the Song Selection Keyboard Keys (10-key)

Hold down the **GRAND PIANO** button and use the C1 to A1 keys to enter the song number.

- Input two digits for the song number.

Song Number	Songs
1 to 60	Built-in Music Library Songs
61 to 70	User Songs
71	MIDI Recorder Song

## Changing Settings Such as the Tone

### GRAND PIANO

Select a key while holding down the **GRAND PIANO** button.

- If you press a key while changing a setting, the number of times the notification tone sounds varies according to the value set and the sequence.
- When you disable a setting, a low tone sounds.

A0	GRAND PIANO BRIGHT
B0	GRAND PIANO MELLOW
C1	GRAND PIANO CONCERT
D1	GRAND PIANO BRIGHT
E1	GRAND PIANO MELLOW
F1	GRAND PIANO CONCERT
G1	GRAND PIANO BRIGHT
A1	GRAND PIANO MELLOW
B1	GRAND PIANO CONCERT
C2	GRAND PIANO BRIGHT
D2	GRAND PIANO MELLOW
E2	GRAND PIANO CONCERT
F2	GRAND PIANO BRIGHT
G2	GRAND PIANO MELLOW
A2	GRAND PIANO CONCERT
B2	GRAND PIANO BRIGHT
C3	GRAND PIANO MELLOW
D3	GRAND PIANO CONCERT
E3	GRAND PIANO BRIGHT
F3	GRAND PIANO MELLOW
G3	GRAND PIANO CONCERT
A3	GRAND PIANO BRIGHT
B3	GRAND PIANO MELLOW
C4	GRAND PIANO CONCERT
D4	GRAND PIANO BRIGHT
E4	GRAND PIANO MELLOW
F4	GRAND PIANO CONCERT
G4	GRAND PIANO BRIGHT
A4	GRAND PIANO MELLOW
B4	GRAND PIANO CONCERT
C5	GRAND PIANO BRIGHT
D5	GRAND PIANO MELLOW
E5	GRAND PIANO CONCERT
F5	GRAND PIANO BRIGHT
G5	GRAND PIANO MELLOW
A5	GRAND PIANO CONCERT
B5	GRAND PIANO BRIGHT
C6	GRAND PIANO MELLOW
D6	GRAND PIANO CONCERT
E6	GRAND PIANO BRIGHT
F6	GRAND PIANO MELLOW
G6	GRAND PIANO CONCERT
A6	GRAND PIANO BRIGHT
B6	GRAND PIANO MELLOW
C7	GRAND PIANO CONCERT
D7	GRAND PIANO BRIGHT
E7	GRAND PIANO MELLOW
F7	GRAND PIANO CONCERT
G7	GRAND PIANO BRIGHT
A7	GRAND PIANO MELLOW
B7	GRAND PIANO CONCERT
C8	GRAND PIANO BRIGHT

Tone Selection

Upper1 Settings

Touch Response

Key Off Response

Split settings

Transpose

Hammer Response

Layer settings

## Free Manuals Download Website

<http://myh66.com>

<http://usermanuals.us>

<http://www.somanuals.com>

<http://www.4manuals.cc>

<http://www.manual-lib.com>

<http://www.404manual.com>

<http://www.luxmanual.com>

<http://aubethermostatmanual.com>

Golf course search by state

<http://golfingnear.com>

Email search by domain

<http://emailbydomain.com>

Auto manuals search

<http://auto.somanuals.com>

TV manuals search

<http://tv.somanuals.com>