

1 Description

Honeywell's TL8230A programmable thermostat can be connected to an electric heater to control the room temperature.

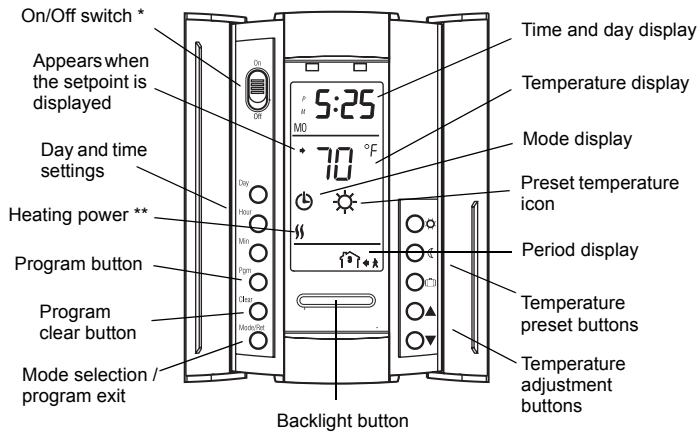

* Set the switch to Off to cut power to the heater. This will not affect the time and temperature settings.

** The thermostat displays the heater duty cycle required to maintain the desired temperature. For example, appears when the heater is activated 40 percent of the time.

Display					
% of duty cycle	1 to 24%	25 to 49%	50 to 74%	75 to 99%	100%

2 Assembly/Disassembly

- To remove the control module from the power base, loosen the captive screw underneath the thermostat and pull the two components apart as shown.
- To install the control module onto the power base, reverse the above procedure.

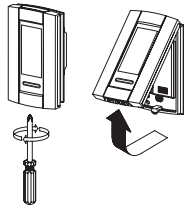

NOTE: Always keep the thermostat's vents clean and unobstructed.

3 Configuration

Some thermostat configurations can be modified via the switches on the back of the control module.

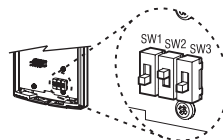

Default (factory) settings are inside the gray cells.

#	Functionality	UP	DN
SW1	Temperature format ^a	°F	°C
SW2	Early Start ^b	Disable	Enable
SW3	Time format	12-hour	24-hour

- If you change the temperature display format, the preset buttons (, , and) will return to their default settings.
- Early Start functions in Automatic mode only. When this function is enabled, the thermostat calculates the optimal time to start heating in order to obtain the desired temperature by the set time. The thermostat re-assesses the start time daily based on the previous day's performance.

4 Power-up

Upon power-up, the thermostat is in manual mode () and displays the actual temperature.

- Press the Hour and Min buttons to set the time.
- Press the Day button to set the day.

5 Error Messages

LO: The measured temperature is below 32°F (0°C). Heating is activated.

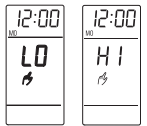

HI: The measured temperature is above 122°F (50°C).

6 Backlight

When the backlight button is pressed, the display illuminates for 5 seconds. When either of the buttons is pressed, the display illuminates for 10 seconds.

7 Temperature Setting

Setpoint

The thermostat generally displays the actual temperature. To view the setpoint, press one of the buttons once or press the backlight button. The setpoint will appear for the next 5 seconds.

To change the setpoint, press one of the buttons until the desired temperature is displayed. To scroll faster, hold the button.

Preset buttons

The thermostat has 3 temperature preset buttons:

- Comfort preset button
- Economy preset button
- Vacation preset button

To use a preset temperature, press the appropriate button. The corresponding icon , , or will be displayed.

The following table shows the intended use and the default setting of each of the preset buttons.

Icon	Intended use	Default setting	New
	Comfort (when at home)	70°F (21°C)	
	Economy (when asleep or away from home)	62°F (16.5°C)	
	Vacation (during prolonged absence)	50°F (10°C)	

To store a preset temperature:

- Set the desired temperature using the buttons.
- Press and hold the appropriate preset button until the corresponding icon is displayed.
- Press Mode/Ret to exit.

8 Operating Modes

The thermostat has 3 operating modes.

Automatic - The temperature is set according to the energy-saving schedule. To place the thermostat in this mode, press Mode/Ret until ☺ is displayed. The current period setting is also displayed.

Temporary Bypass: If you modify the setpoint (by pressing the ▲▼, ✨ or ⌂ button) when the thermostat is in automatic mode, the new setpoint will be used until the beginning of the next period.

Manual - The energy-saving schedule is not used. The temperature must be set manually. To place the thermostat in this mode:

- 1 Press Mode/Ret until ⚡ is displayed.
- 2 Set the temperature using the ▲▼, ✨ or ⌂ button.

Vacation - The thermostat is set to the Vacation temperature. Press 🏠 to place the thermostat in Vacation mode.

9 Energy-saving Schedule

The schedule consists of 4 periods per day which represents a typical week day. You can program the thermostat to skip the periods that do not apply to your situation. For example, you can skip periods 2 and 3 for the weekend.

Period	Description	Associated temperature setting
☺	Wake-up	☺
☾	Away from home	☾
☺	Return home	☺
☾	Sleep	☾

The Comfort (☺) temperature is used in periods 1 and 3 and the Economy (☾) temperature is used in periods 2 and 4. For example, when the period changes from 1 to 2, the setpoint automatically changes from Comfort setting (☺) to Economy setting (☾).

You can have a different program for each day of the week; i.e., each period can start at different time for each day of the week. The thermostat has been programmed with the following schedule.

Period	Setting	MO	TU	WE	TH	FR	SA	SU
☺	☺	6:00 am	6:00 am	6:00 am	6:00 am	6:00 am	6:00 am	6:00 am
☾	☾	8:00 am	8:00 am	8:00 am	8:00 am	8:00 am	--:--	--:--
☺	☺	6:00 pm	6:00 pm	6:00 pm	6:00 pm	6:00 pm	--:--	--:--
☾	☾	10:00 pm	10:00 pm	10:00 pm	10:00 pm	10:00 pm	10:00 pm	10:00 pm

To modify the schedule:

- 1 Press Pgm to access the programming mode. Period 1 is selected.
- 2 Press Day to select the day to program (hold for 3 seconds to select the entire week).
- 3 Press Hour and Min to set the start time of the selected period, or press Clear if you want to skip the period (--:-- is displayed).
- 4 Press Pgm to select another period, or press Day to select another day. Then repeat step 3.
- 5 Press Mode/Ret to exit the programming mode.

NOTE: If no button is pressed for 60 seconds, the thermostat will automatically exit the programming mode.

Use the following grid to record the new schedule.

Period	Setting	MO	TU	WE	TH	FR	SA	SU
☺	☺							
☾	☾							
☺	☺							
☾	☾							

10 Technical Specifications

Power supply: refer to the power base installation instructions

Display range: 32°F to 140°F (0°C to 60°C)

Setpoint range: 40°F to 86°F (5°C to 30°C)

Display resolution: 1°F (0.5°C)

Storage: -4°F to 120°F (-20°C to 50°C)

Heating cycle length: 15 minutes

Data backup: In the event of a power failure, most settings are saved. Only the time must be re-adjusted if the power failure lasts more than 2 hours. The thermostat will return to the mode that was active prior to the power failure.

✓ Warranty

Honeywell warrants this product, excluding battery, to be free from defects in the workmanship or materials, under normal use and service, for a period of five (5) years from the date of purchase by the consumer. If at any time during the warranty period the product is determined to be defective or malfunctions, Honeywell shall repair or replace it (at Honeywell's option).

If the product is defective,

- (i) return it, with a bill of sale or other dated proof of purchase, to the place from which you purchased it, or
- (ii) call Honeywell Customer Care at 1-800-468-1502. Customer Care will make the determination whether the product should be returned to the following address: Honeywell Return Goods, Dock 4 MN10-3860, 1885 Douglas Dr N, Golden Valley, MN 55422, or whether a replacement product can be sent to you.

This warranty does not cover removal or reinstallation costs. This warranty shall not apply if it is shown by Honeywell that the defect or malfunction was caused by damage which occurred while the product was in the possession of a consumer.

Honeywell's sole responsibility shall be to repair or replace the product within the terms stated above. HONEYWELL SHALL NOT BE LIABLE FOR ANY LOSS OR DAMAGE OF ANY KIND, INCLUDING ANY INCIDENTAL OR CONSEQUENTIAL DAMAGES RESULTING, DIRECTLY OR INDIRECTLY, FROM ANY BREACH OF ANY WARRANTY, EXPRESS OR IMPLIED, OR ANY OTHER FAILURE OF THIS PRODUCT. Some states do not allow the exclusion or limitation of incidental or consequential damages, so this limitation may not apply to you.

THIS WARRANTY IS THE ONLY EXPRESS WARRANTY HONEYWELL MAKES ON THIS PRODUCT. THE DURATION OF ANY IMPLIED WARRANTIES, INCLUDING THE WARRANTIES OF MERCHANTABILITY AND FITNESS FOR A PARTICULAR PURPOSE, IS HEREBY LIMITED TO THE FIVE-YEAR DURATION OF THIS WARRANTY. Some states do not allow limitations on how long an implied warranty lasts, so the above limitation may not apply to you.

This warranty gives you specific legal rights, and you may have other rights which vary from state to state.

If you have any questions concerning this warranty, please write Honeywell Customer Relations, 1985 Douglas Dr, Golden Valley, MN 55422 or call 1-800-468-1502. In Canada, write Retail Products ON15-02H, Honeywell Limited/Honeywell Limitée, 35 Dynamic Drive, Scarborough, Ontario M1V4Z9.



Customer Assistance

If you have any questions about the operation of your thermostat, please go to www.honeywell.com/yourhome, or call Honeywell Customer Care toll-free at 1-800-468-1502.

Free Manuals Download Website

<http://myh66.com>

<http://usermanuals.us>

<http://www.somanuals.com>

<http://www.4manuals.cc>

<http://www.manual-lib.com>

<http://www.404manual.com>

<http://www.luxmanual.com>

<http://aubethermostatmanual.com>

Golf course search by state

<http://golfingnear.com>

Email search by domain

<http://emailbydomain.com>

Auto manuals search

<http://auto.somanuals.com>

TV manuals search

<http://tv.somanuals.com>