

Honeywell

ADEMCO 5804E WIRELESS KEY TRANSMITTER

INSTALLATION AND SETUP GUIDE

GENERAL INFORMATION

The ADEMCO 5804E is a compact, 4-button portable wireless transmitter intended for use only with wireless alarm systems that support 5800 Series receivers. Each button on the transmitter may be programmed for any zone response, but is typically used for arming and disarming.

This device supports the High-Security mode, which sends rolling-code encrypted messaging to the RF receiver.

Important Note: This device must be used with a 5881EN or a 6128RF (UL version) receiver.

The 5804E is powered by two replaceable lithium batteries designed to provide up to 4 years of life. For battery installation, see **Replacing the Batteries**.

PROGRAMMING

Each 5804E is assigned a unique serial number during manufacture. Each button on the unit also has a distinct "loop" number (refer to Figure 1) that you must program into the control panel during installation. Assign each button to an individual zone and designate the Input Type as "BR" (Button Type RF).

When you are prompted for the serial number, either press and release twice the button you are programming, or enter it manually through the keypad.

For complete details on how to program the 5804E transmitter's serial number at the control panel, see the control unit's installation instructions.

Note: Buttons on this transmitter must be pressed for at least 1/2 second to activate the transmitter. This feature minimizes the possibility of accidental transmissions.

ACTIVATING HIGH-SECURITY MODE

If Programming 5804E in the Control

1. Program the button in the control.
2. After programming is complete, exit programming mode and wait 60 seconds.
3. Put the system in Go/No Go mode.
4. Press all 4 buttons on the 5804E at the same time until the panel beeps.
5. To sync the device in High Security Mode, press any button ONCE, until the panel beeps indicating receipt.

NOTE: If no beep is heard, exit Go/No Go mode, and repeat this procedure from Step 3.

6. Exit Go/No Go mode (user code + 1 (OFF)).

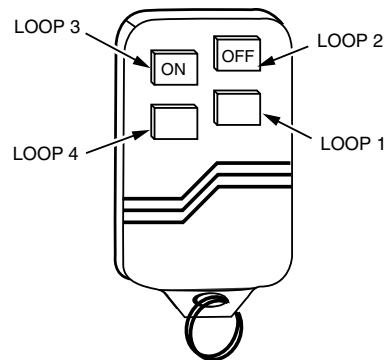

Figure 1: 5804E showing button designations

PROGRAMMING THE 5804E LOCALLY IN AN RF KEYPAD (E.G., 6150RF)

Hold all 4 buttons down while enrolling the serial number in the RF keypad.

USING TWO RECEIVERS IN HIGH-SECURITY MODE

Enroll the 5804E into the receivers one at a time, by disconnecting Receiver #2, enrolling as described in "Activating High Security Mode" (above). Then, disconnect Receiver #1, reconnect Receiver #2, and repeat the enrollment procedure. This process ensures proper High Security operation with both receivers.

APPLYING COLORED ADHESIVE LABELS AND BUTTONS

The 5804E is supplied with colored buttons (red and blue) and colored adhesive identification labels (blue, red, gray, and green). Each label has a specified command function and symbol printed on it, as well as an adhesive back for easy pasting.

To paste a label on a button, slowly peel off a label with a selected function and paste it on the button of the transmitter. If you decide later to re-enroll a button, the label can be easily removed or a new label pasted over the existing one.

Additional colored buttons (red and blue) are also provided which can be used with or without the labels. The buttons can be inserted only in the areas provided for them (see Figure 3).

To insert the colored buttons, do the following:

1. Holding the transmitter with the buttons face down, remove the case back by using the blade of a small screwdriver to pry it open (see Figure 2).
2. Carefully remove the PC board by its rubber casing, making sure the board does not come out of the casing. Do not bend the exposed battery tabs on the PC board.
3. Replace the desired buttons, either red or blue, in each button's designated opening (see Figure 3).
4. When finished, replace the PC board, making sure the button tabs on the board face the four buttons, and snap the case front and back together.

After inserting the new buttons, we recommend you check the 5804E for proper operation.

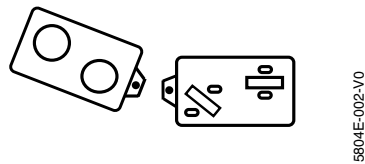

Figure 2: Battery tabs shown

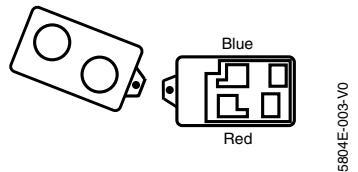
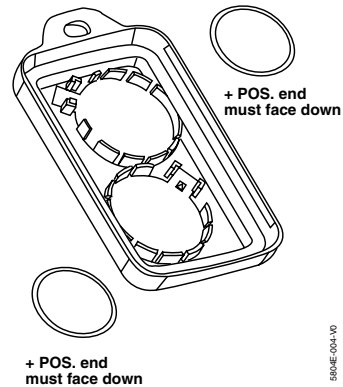

Figure 3: 5804E shown open, buttons facing down



REPLACING THE BATTERIES

1. Remove case back by using the blade of a small screwdriver to pry it open.
2. Remove old batteries.
3. Place batteries in case back locations (see diagram above). **+ POS END MUST FACE DOWN.**
4. To close, snap case front and back together.

Important Note: Do not remove Printed Circuit Board.

SPECIFICATIONS

Unit Dimensions:

2.25" W x 1.50"H x 0.5" D

57mm W x 38mm H x 12.7mm D

Battery:

Maxell CR2025, Duracell DL 2025, or Varta CR2025

FOR WARRANTY INFORMATION AND FOR DETAILS REGARDING THE LIMITATIONS OF THE ENTIRE ALARM SYSTEM, REFER TO THE INSTALLATION INSTRUCTIONS FOR THE RECEIVER/CONTROL WITH WHICH THIS DEVICE IS USED.

FCC NOTICE

THIS DEVICE COMPLIES WITH PART 15 OF FCC RULES. OPERATION IS SUBJECT TO THE FOLLOWING TWO CONDITIONS: (1) THIS DEVICE MAY NOT CAUSE HARMFUL INTERFERENCE, AND (2) THIS DEVICE MUST ACCEPT ANY INTERFERENCE RECEIVED, INCLUDING INTERFERENCE THAT MAY CAUSE UNDESIRE OPERATION.

FCC ID: CFS8DL5804E

CANADA: 573F-5804E

Honeywell

165 Eileen Way, Syosset, New York 11791

Copyright © 2004 Honeywell International Inc.

www.security.honeywell.com



N7674-6V2 10/04 Rev. A

Free Manuals Download Website

<http://myh66.com>

<http://usermanuals.us>

<http://www.somanuals.com>

<http://www.4manuals.cc>

<http://www.manual-lib.com>

<http://www.404manual.com>

<http://www.luxmanual.com>

<http://aubethermostatmanual.com>

Golf course search by state

<http://golfingnear.com>

Email search by domain

<http://emailbydomain.com>

Auto manuals search

<http://auto.somanuals.com>

TV manuals search

<http://tv.somanuals.com>